

VOUET ... SENSOR



Sammode

Notice de montage

Mounting instruction

Montageanleitung

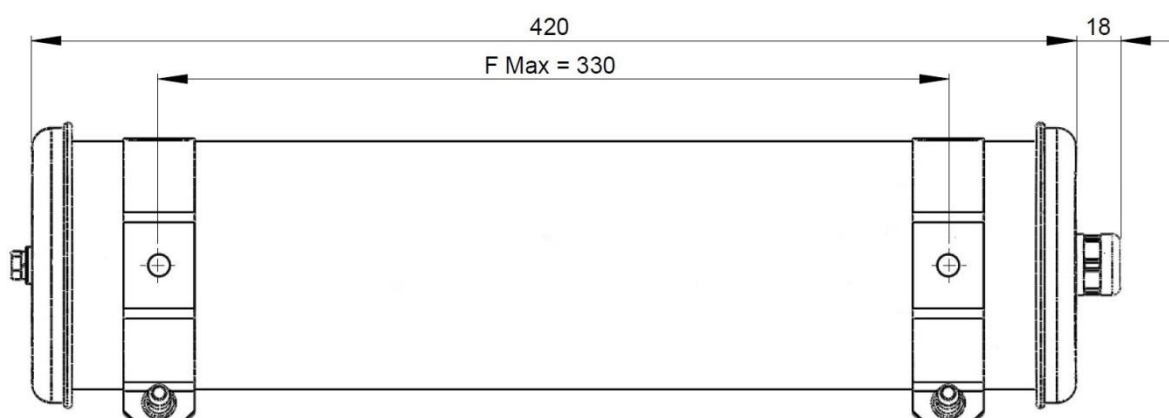
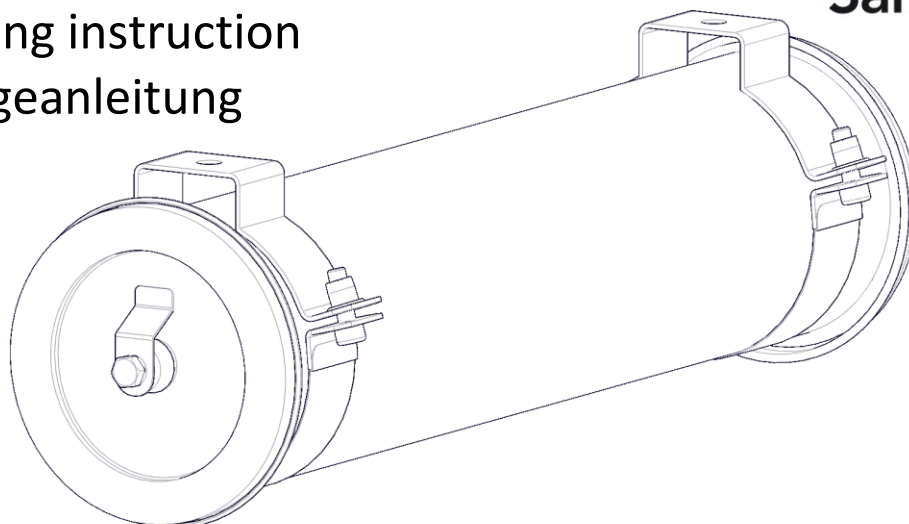

Ne pas ouvrir sous tension
Do not open when energized
Nicht unter Spannung öffnen

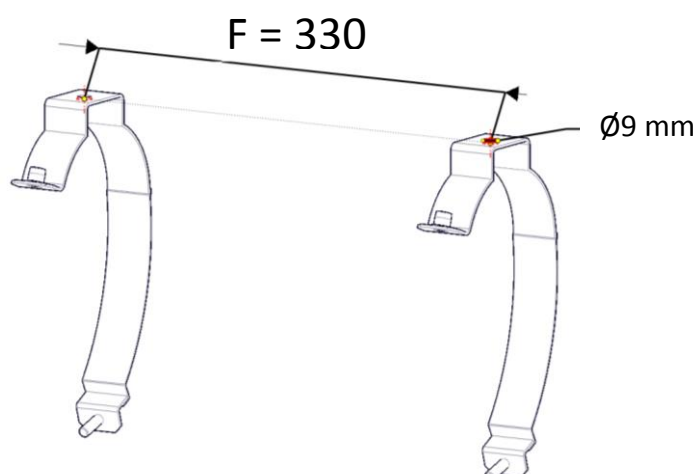

Installation & raccordement / Wiring / Verkabelung

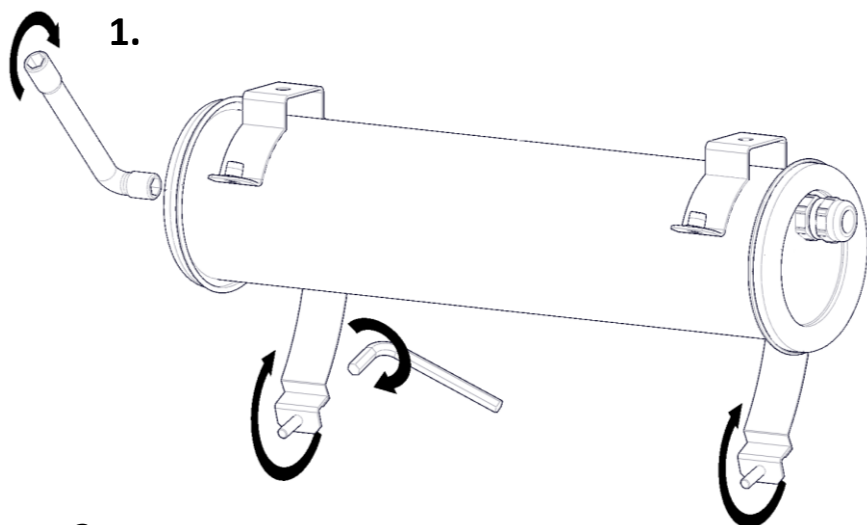
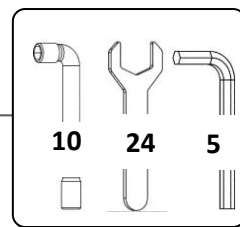

2.

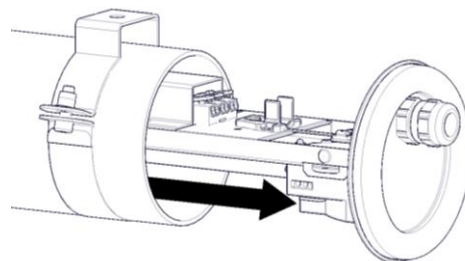

3.

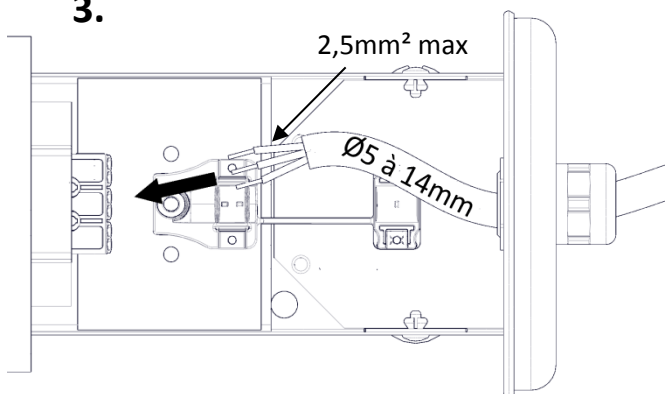

Option repiquage (...213LN)

	L	N
Modèle ON-OFF	L	N
Modèle ON-10% (...MV10)	L	N

(L')
si repiquage du signal de présence
si repiquage du signal de présence

**Raccordement si repiquage
Wiring in chain**

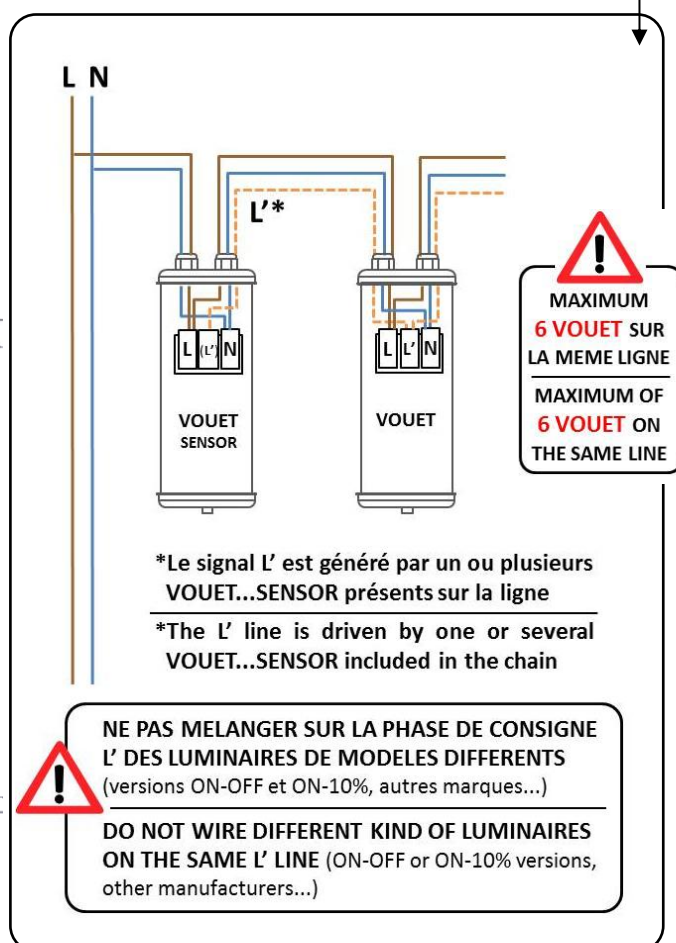

4.

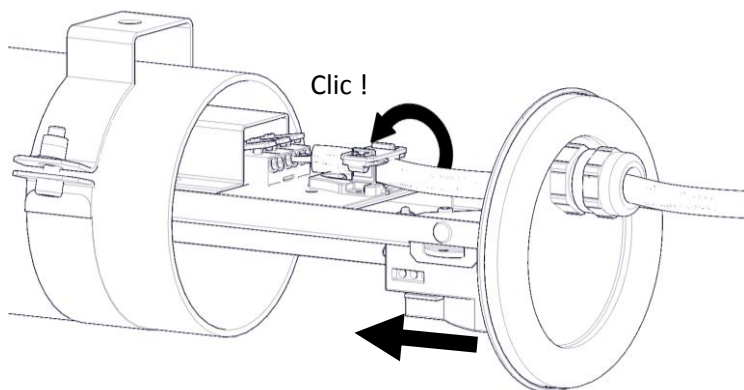

5.

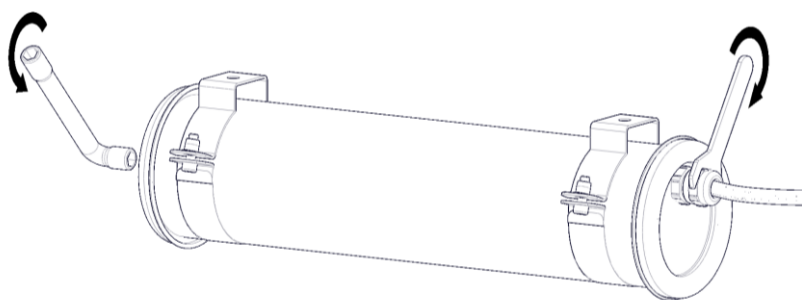

1. Position & câble / Position & cable / Position & Kabel

Horizontal

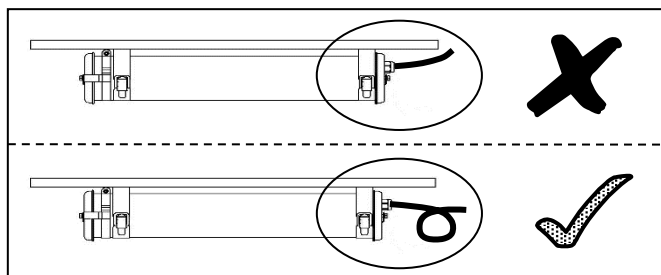

Vertical

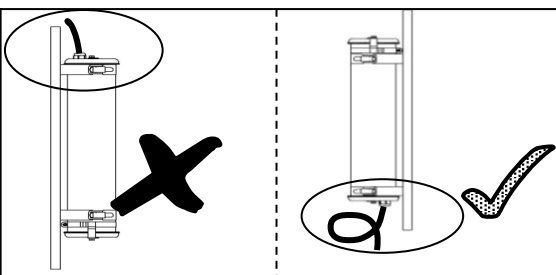

2. Flasques / End caps / Endkappen

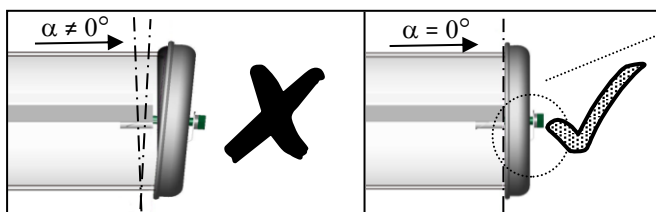

3. Vis centrale / Central screw / Zentrale Schraube

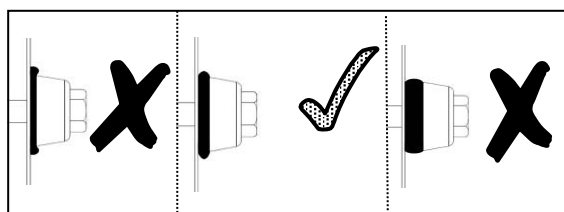

Maintenance / Maintenance / Wartung

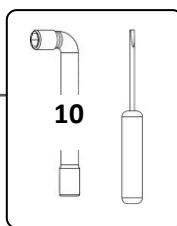

Ne pas ouvrir sous tension
Do not open when energized
Nicht unter Spannung öffnen

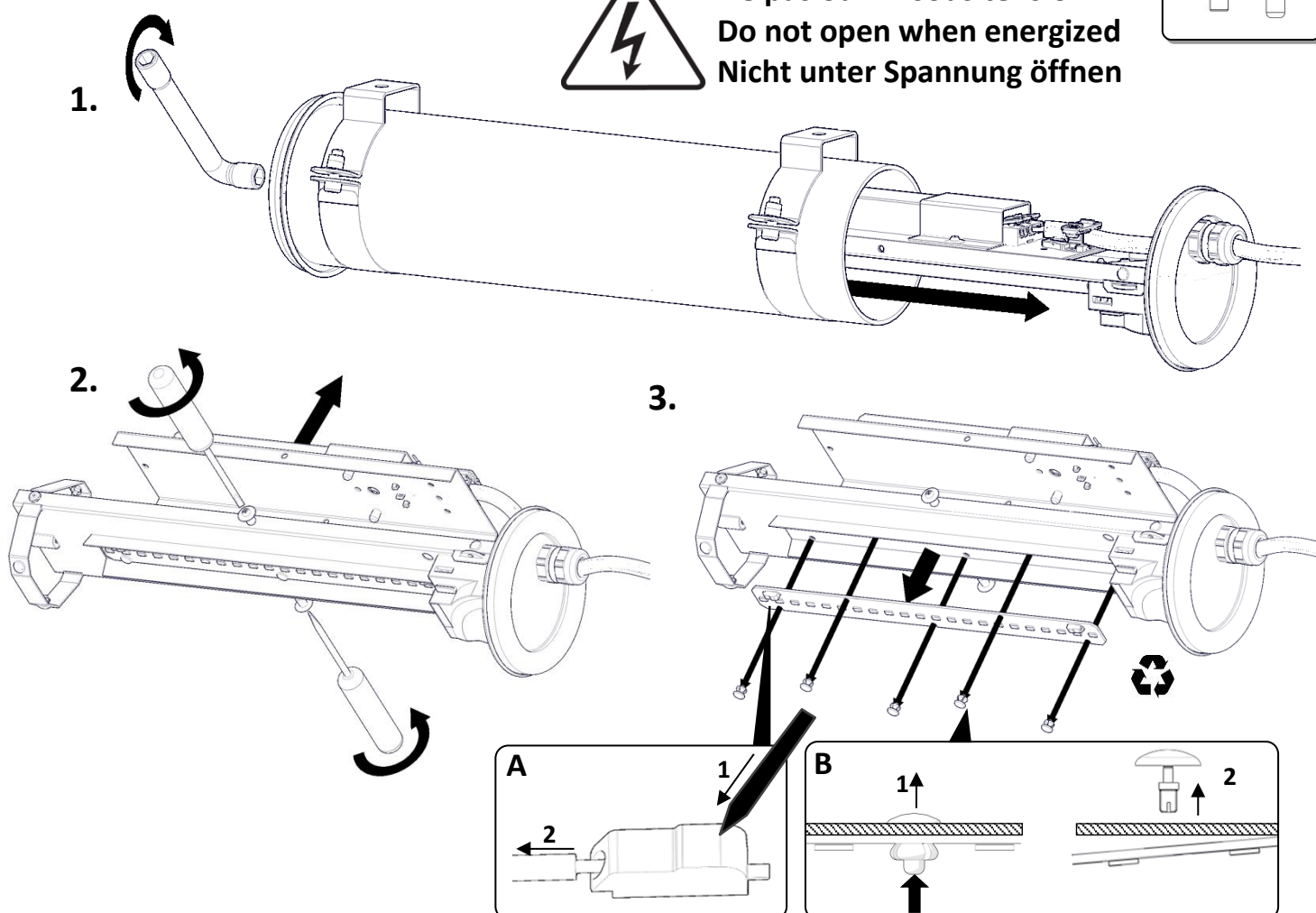

Réglage du capteur

Définir le seuil

Un seuil peut être défini afin d'éviter un allumage inutile de l'éclairage lorsque l'éclairement est suffisant.

Le seuil indique jusqu'à quel éclairement les mouvements détectés déclenchent un allumage de l'éclairage.

Plage de valeurs

2 – 50 lx ; en continu

Position I

Seuil de détection continue

Position V

Seuil 2 lx

	7	8	9	Daylight sensor
I	●	●	●	Disable (default)
II	○	●	●	50 Lux
III	○	●	○	20 Lux
IV	○	○	●	5 Lux
V	○	○	○	2 Lux

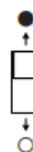

Définir la zone de couverture

Cette zone peut être limitée afin d'éviter un allumage inutile de l'éclairage en raison d'une zone de couverture trop importante. La zone de couverture définit le diamètre dans lequel les mouvements sont détectés.

Plage de valeurs

En continu ; fonction de la hauteur de montage

Position I

Zone de couverture maximale

Position V

Zone de couverture minimale

Sensitivity

h	100 %	75 %	50 %	30 %	10 %
	d				
0.5 m	5.0 m	3.0 m	1.5 m	1.0 m	0.50 m
1.0 m	6.0 m	4.0 m	3.0 m	2.0 m	1.00 m
1.5 m	6.5 m	4.0 m	3.0 m	2.0 m	1.00 m
2.0 m	7.0 m	4.5 m	3.5 m	2.5 m	1.00 m
2.5 m	7.0 m	4.5 m	3.5 m	2.0 m	1.50 m
3.0 m	7.5 m	5.5 m	4.0 m	1.5 m	0.50 m
3.5 m	5.5 m	3.5 m	2.0 m	0.5 m	0.25 m
4.0 m	5.5 m	3.0 m	1.5 m	0.5 m	0.25 m
4.5 m	3.5 m	2.0 m	1.0 m	0.5 m	0.25 m
5.0 m	3.0 m	1.5 m	1.0 m	0.5 m	0.25 m

	1	2	3	Sensitivity
I	●	●	●	100 % (default)
II	○	●	●	75 %
III	○	●	○	50 %
IV	○	○	●	30 %
V	○	○	○	10 %



Définir la temporisation

Une temporisation peut être définie afin d'éviter l'allumage/l'extinction inutile de l'éclairage. La temporisation démarre après le dernier mouvement intervenu dans la zone de couverture. Si un autre mouvement est détecté dans la couverture durant la temporisation, celle-ci redémarre à zéro.

Plage de valeurs

30 s – 30 min ; en continu

Position VII

30 min

Position I

30 s

	4	5	6	Hold time
I	●	●	●	5 s (default)
II	●	○	●	30 s
III	●	○	○	1 min
IV	○	●	●	5 min
V	○	●	○	10 min
VI	○	○	●	20 min
VII	○	○	○	30 min

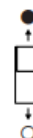

Ceiling mounted:

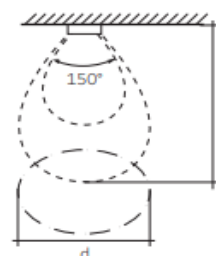

Wall mounted:

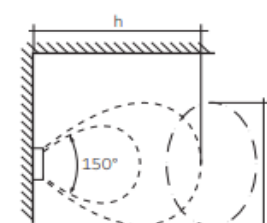

Setting up the sensor

Setting a threshold

A threshold can be set to prevent the lighting from switching on unnecessarily when illuminance levels are sufficient. The threshold indicates the maximum illuminance at which the lighting switches on if motion is detected.

<u>Value range</u>	2 – 50 lx ; smooth adjustment or disable
<u>Position I</u>	Disable
<u>Position V</u>	threshold 2 lx

	7	8	9	Daylight sensor
I	●	●	●	Disable (default)
II	○	●	●	50 Lux
III	○	●	○	20 Lux
IV	○	○	●	5 Lux
V	○	○	○	2 Lux



Setting a detection range

The detection range can be restricted to prevent the lighting from switching on unnecessarily because the range is too large. The detection range indicates the diameter in which motion is detected.

<u>Value range</u>	smooth adjustment; depends on installation height
<u>Position I</u>	maximum detection range
<u>Position V</u>	minimum detection range
<u>Sensitivity</u>	

h	100 %	75 %	50 %	30 %	10 %
	d				
0.5 m	5.0 m	3.0 m	1.5 m	1.0 m	0.50 m
1.0 m	6.0 m	4.0 m	3.0 m	2.0 m	1.00 m
1.5 m	6.5 m	4.0 m	3.0 m	2.0 m	1.00 m
2.0 m	7.0 m	4.5 m	3.5 m	2.5 m	1.00 m
2.5 m	7.0 m	4.5 m	3.5 m	2.0 m	1.50 m
3.0 m	7.5 m	5.5 m	4.0 m	1.5 m	0.50 m
3.5 m	5.5 m	3.5 m	2.0 m	0.5 m	0.25 m
4.0 m	5.5 m	3.0 m	1.5 m	0.5 m	0.25 m
4.5 m	3.5 m	2.0 m	1.0 m	0.5 m	0.25 m
5.0 m	3.0 m	1.5 m	1.0 m	0.5 m	0.25 m

	1	2	3	Sensitivity
I	●	●	●	100 % (default)
II	○	●	●	75 %
III	○	●	○	50 %
IV	○	○	●	30 %
V	○	○	○	10 %



Setting a run-on time

A run-on time can be set to prevent the lighting from switching on and off unnecessarily. The run-on time starts after the last motion has been detected. If further motion is registered in the detection range during the run-on time, this time starts over again.

<u>Value range</u>	30 s – 30 min ; smooth adjustment
<u>Position VII</u>	30 min
<u>Position I</u>	30 s

	4	5	6	Hold time
I	●	●	●	5 s (default)
II	●	○	●	30 s
III	●	○	○	1 min
IV	○	●	●	5 min
V	○	●	○	10 min
VI	○	○	●	20 min
VII	○	○	○	30 min

