

MORISOT 100



Sammode

Notice de montage

Mounting instruction

Montageanweisung

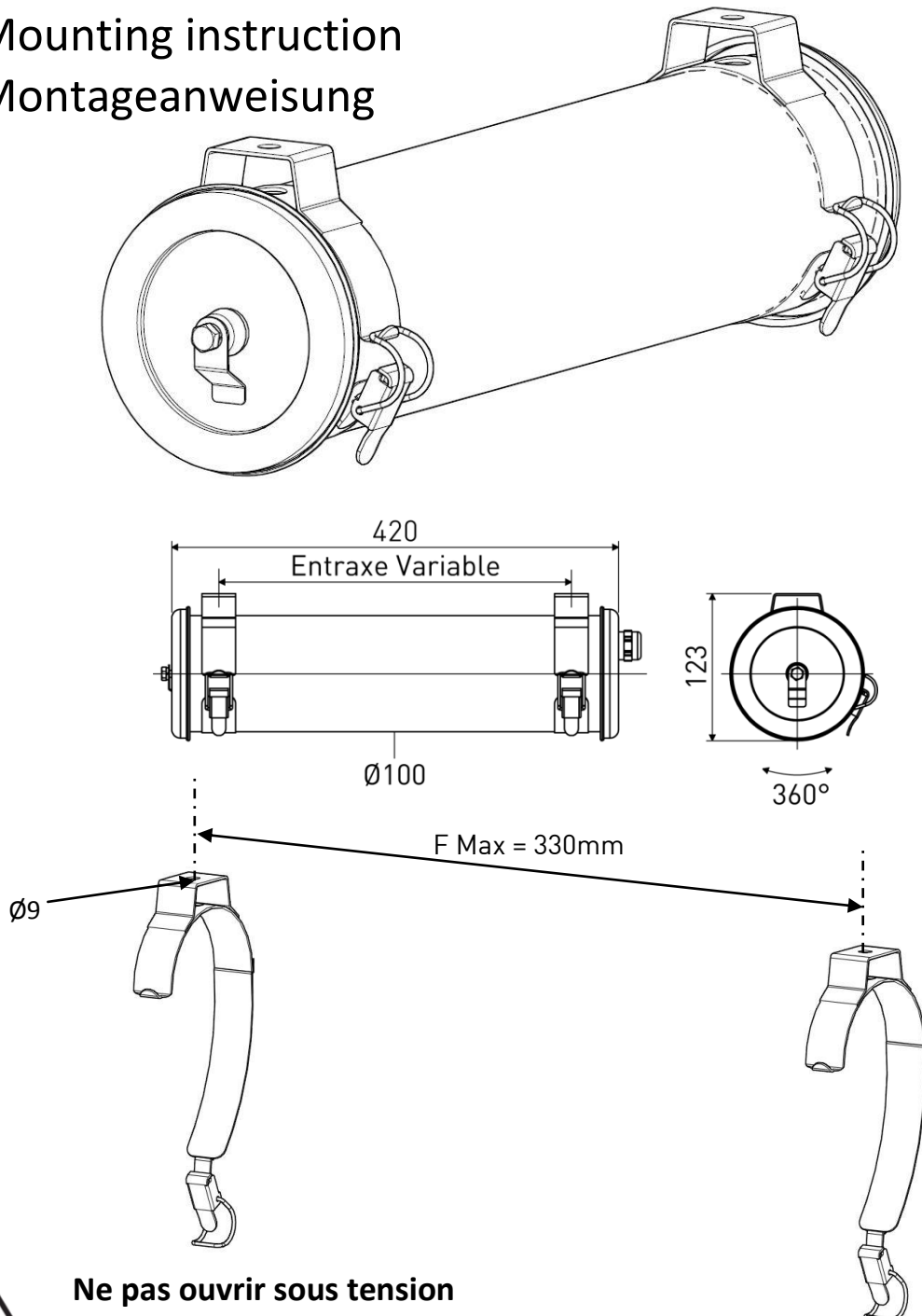

Ne pas ouvrir sous tension
Do not open when energized
Nicht unter Spannung öffnen



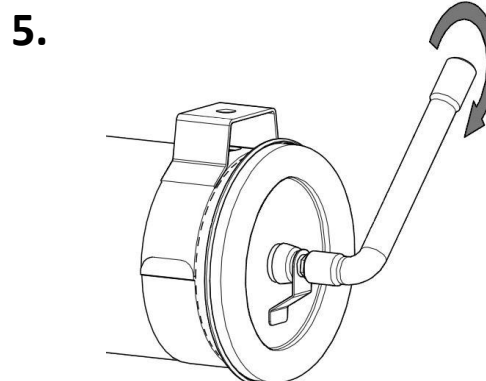
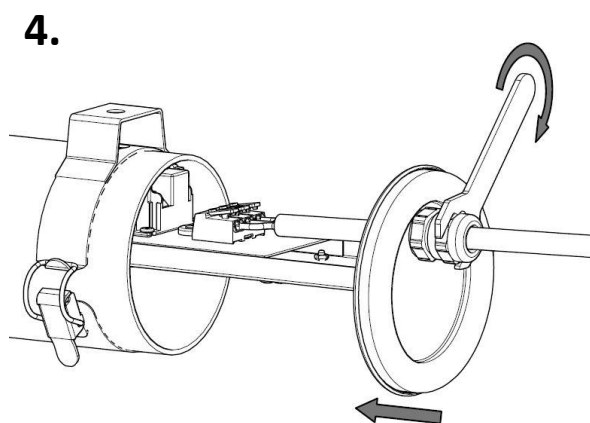
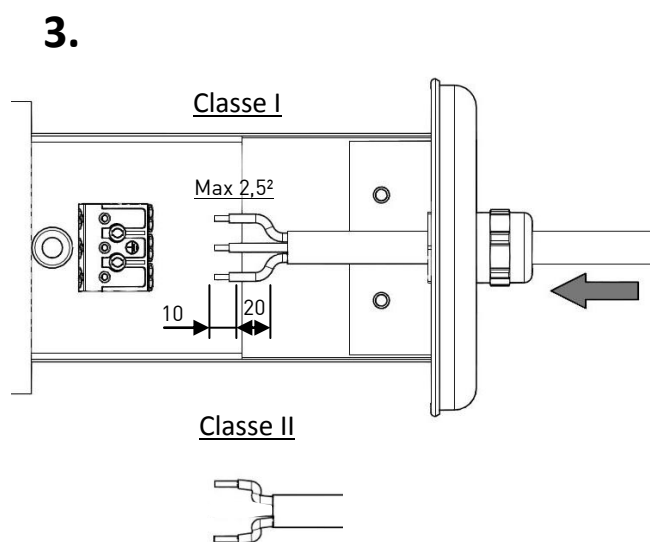
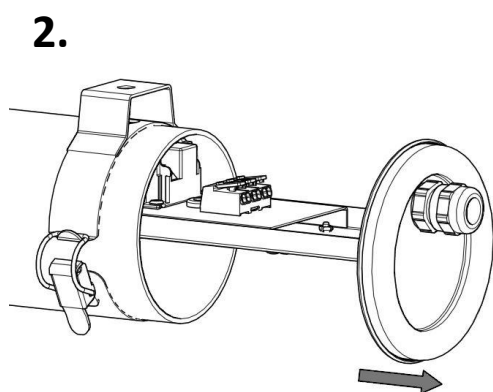
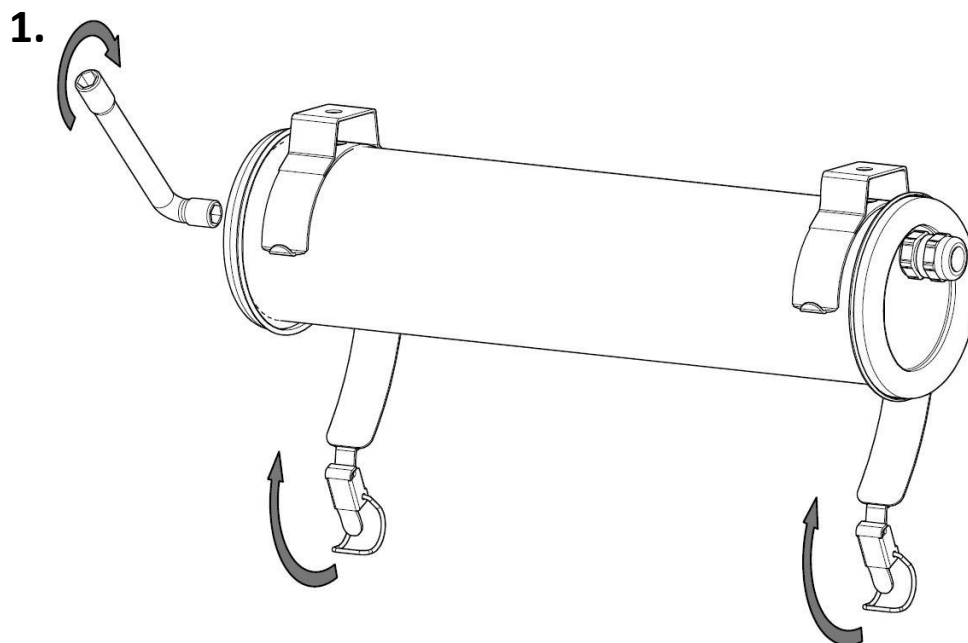
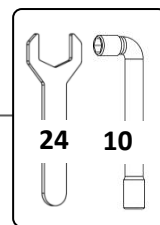

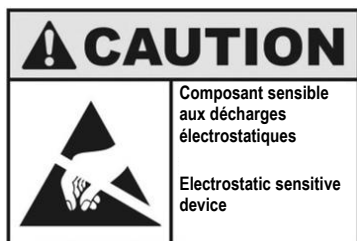

Maintenance du module de LED

Replacement of LED Engine / Austausch der LED module

10



Ne pas ouvrir sous tension
Do not open when energized
Nicht unter Spannung öffne

1.

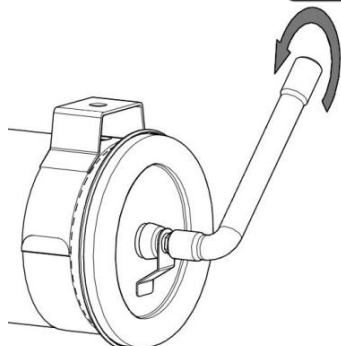

2.

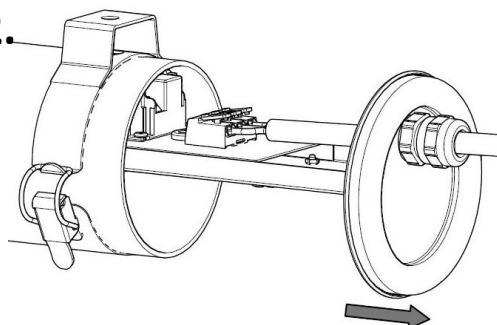

3.

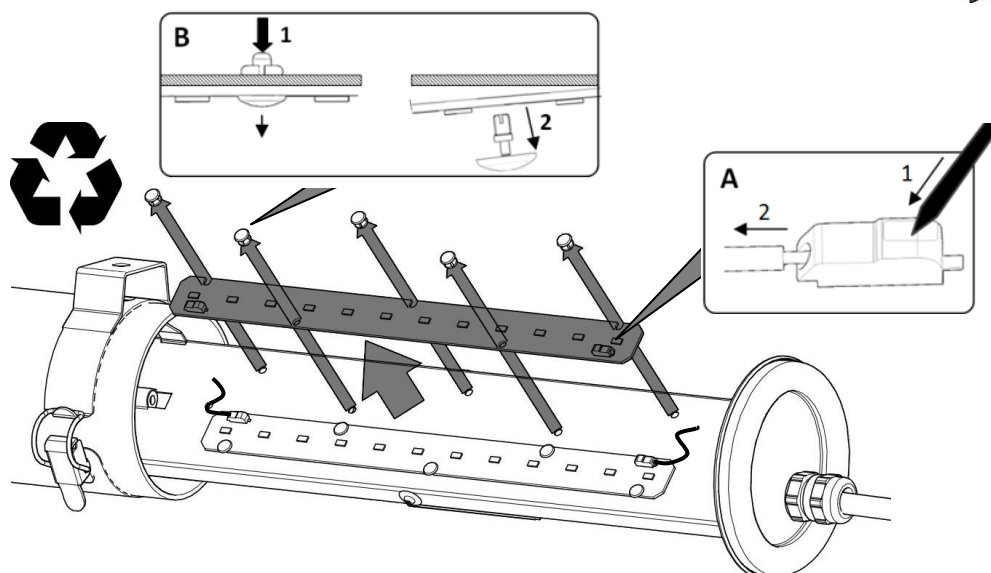

4.

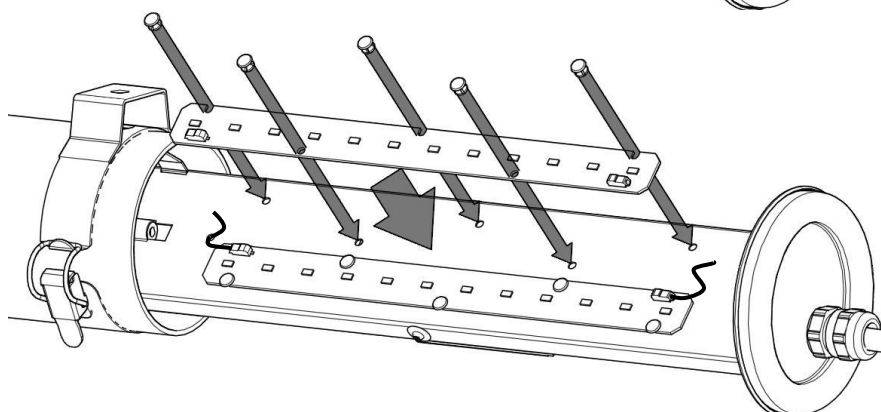

5.

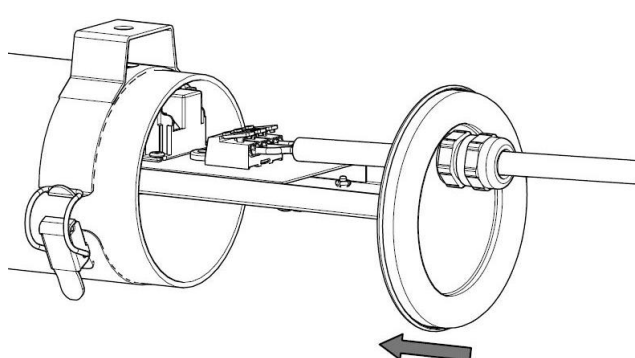

6.

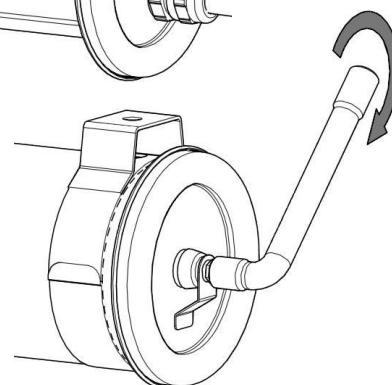

1. Position & câble / Position & cable / Position & kabel

Horizontal

Vertical

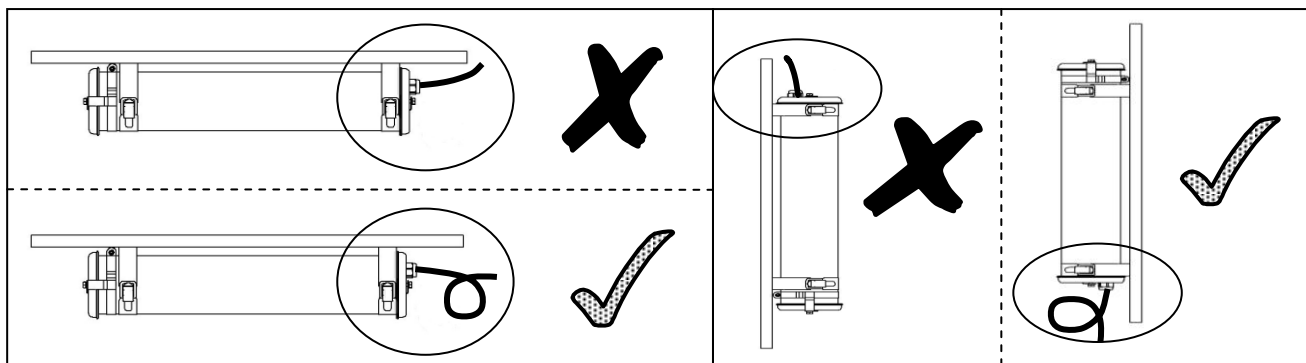

2. Flasques / End caps / Endkappen

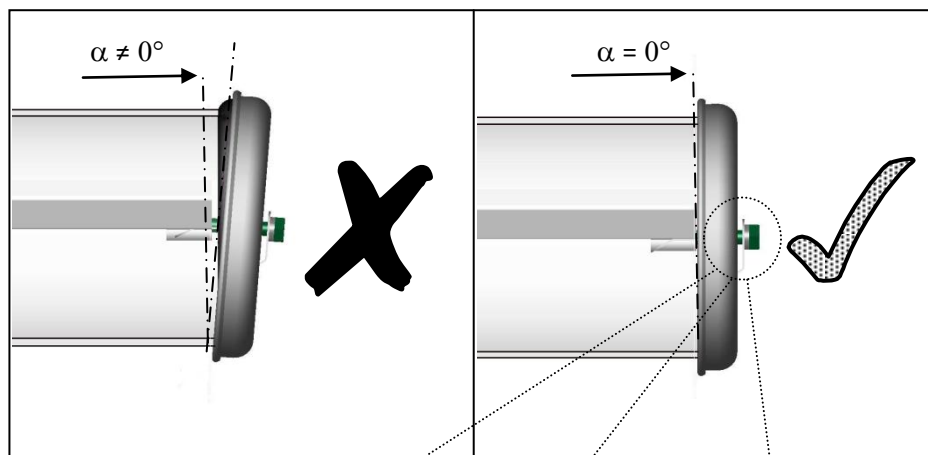

3. Vis centrale / Central screw / Zentrale schraube

