

# MABUSE 133



Sammode

## Notice de montage

Mounting instruction / Montageanweisung

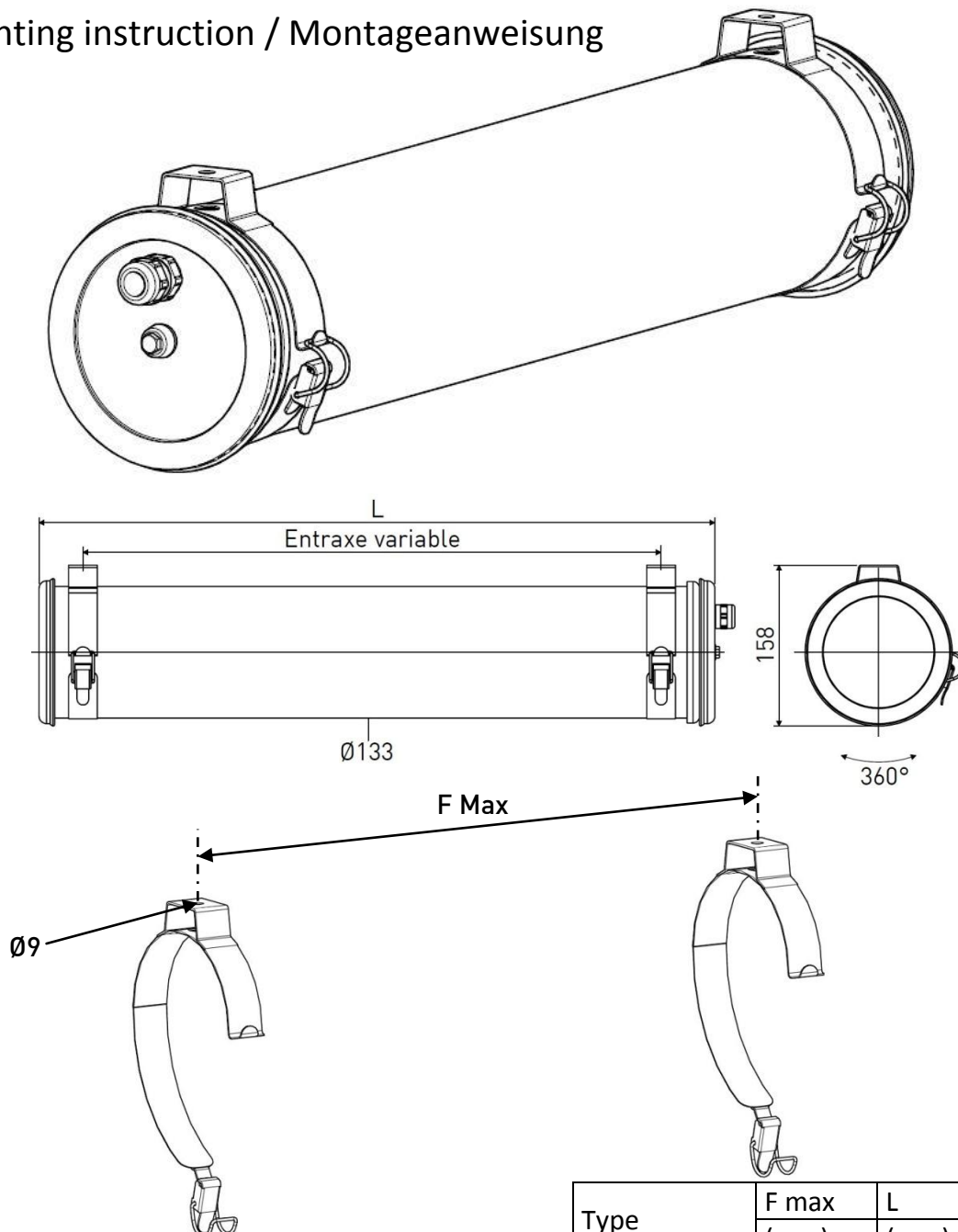

Ne pas ouvrir sous tension  
Do not open when energized  
Nicht unter Spannung öffne

Type	F max (mm)	L (mm)	Poids (Kg)
10W	604	700	2,9
15W	914	1010	3,6
20W	1214	1310	4,3
25W	1514	1610	5,0
30W	1769	1865	5,7

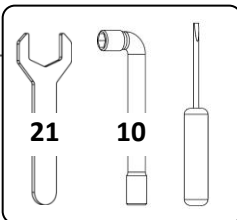

1.

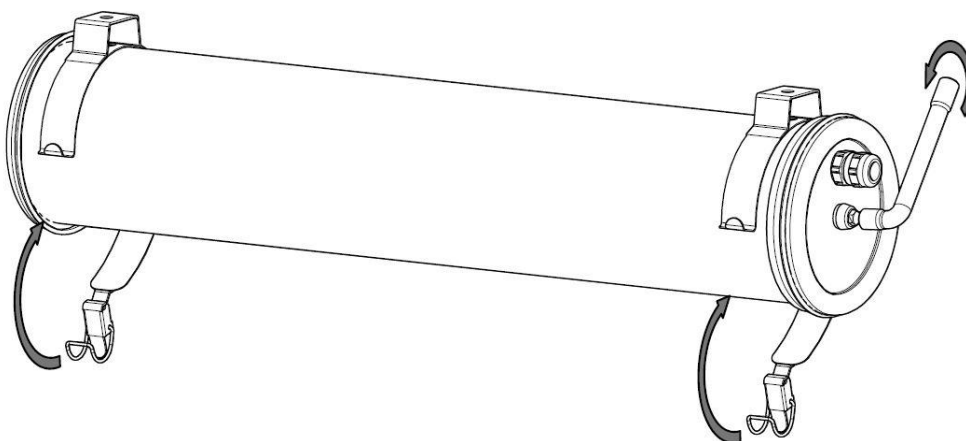

2.

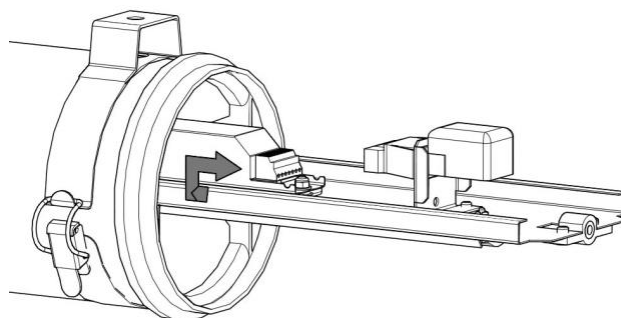
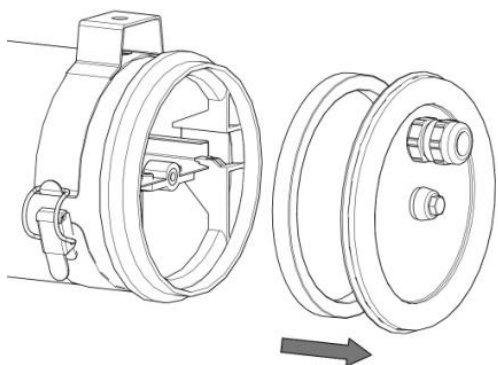

4.

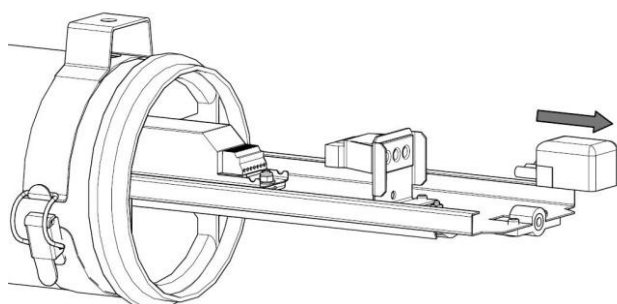

5.

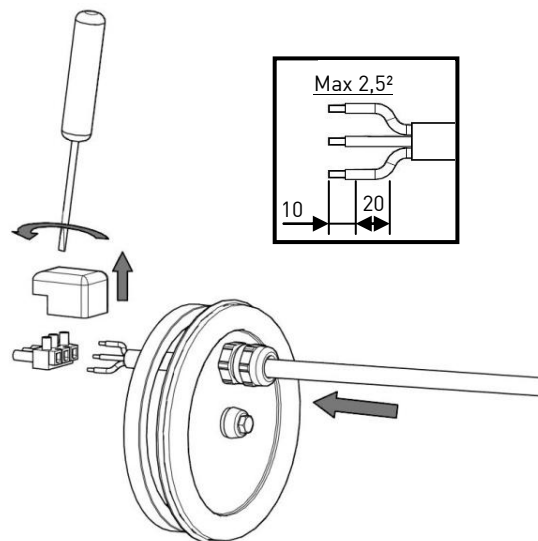

6.

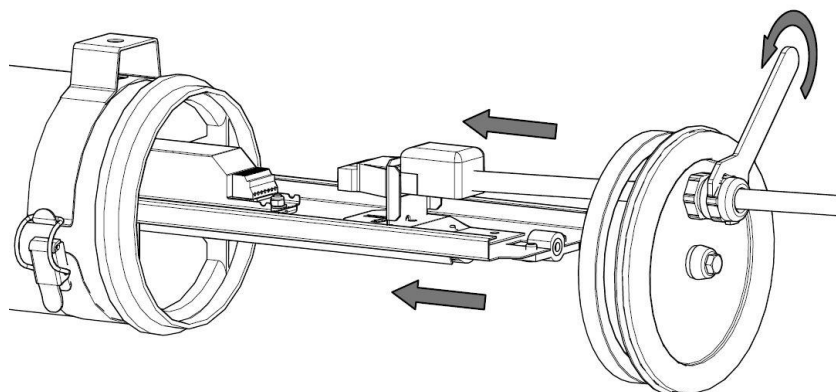

7.

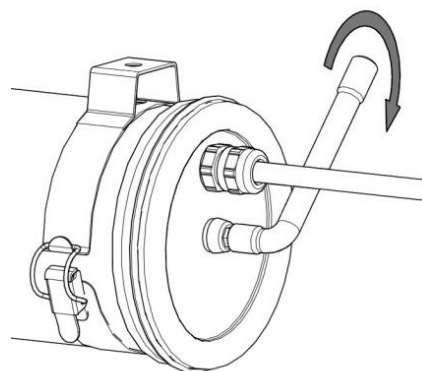

**! CAUTION**

Composant sensible  
aux décharges  
électrostatiques

Electrostatic  
sensitive device

## Maintenance du module de LED Replacement of LED Engine / Austausch der LED module



10



Ne pas ouvrir sous tension  
Do not open when energized  
Nicht unter Spannung öffne

1.

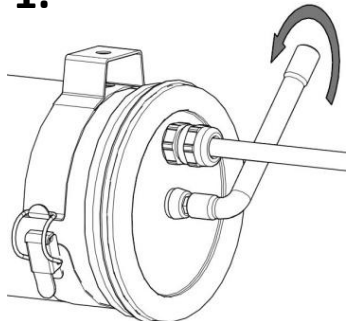

2.

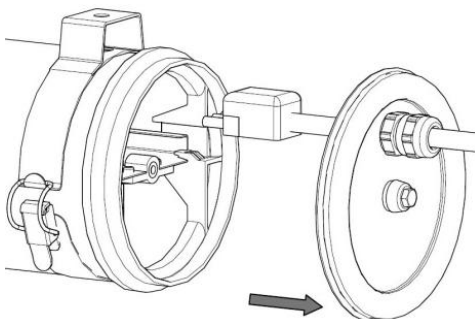

3.

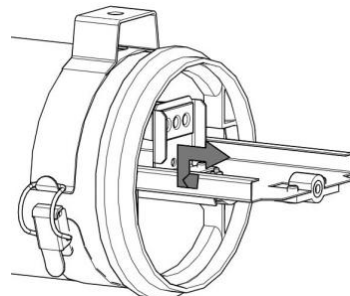

4.

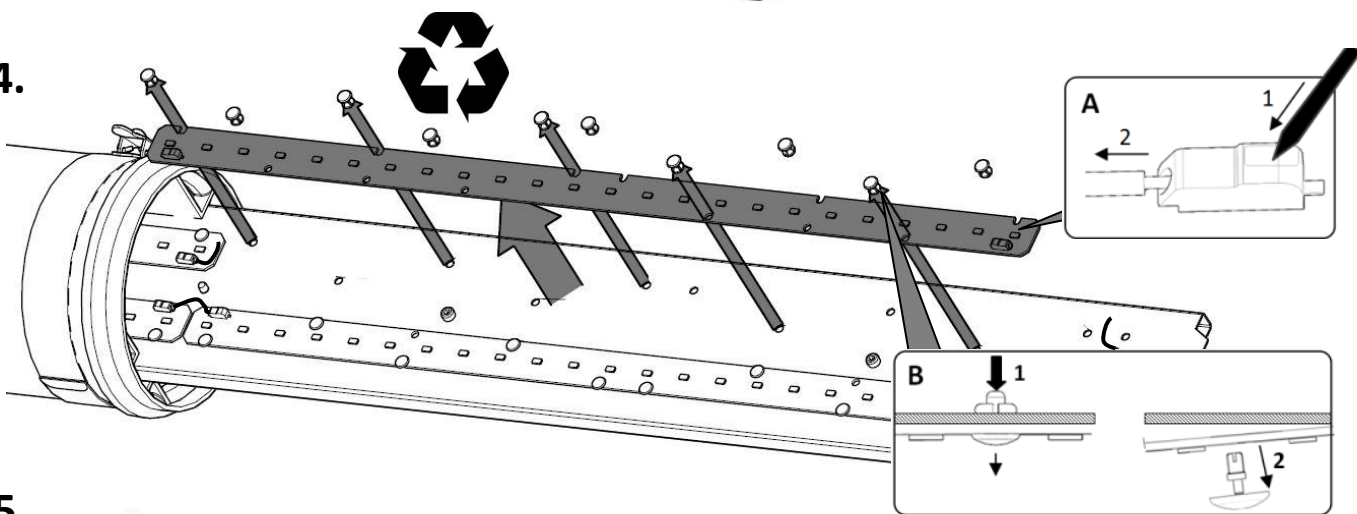

5.

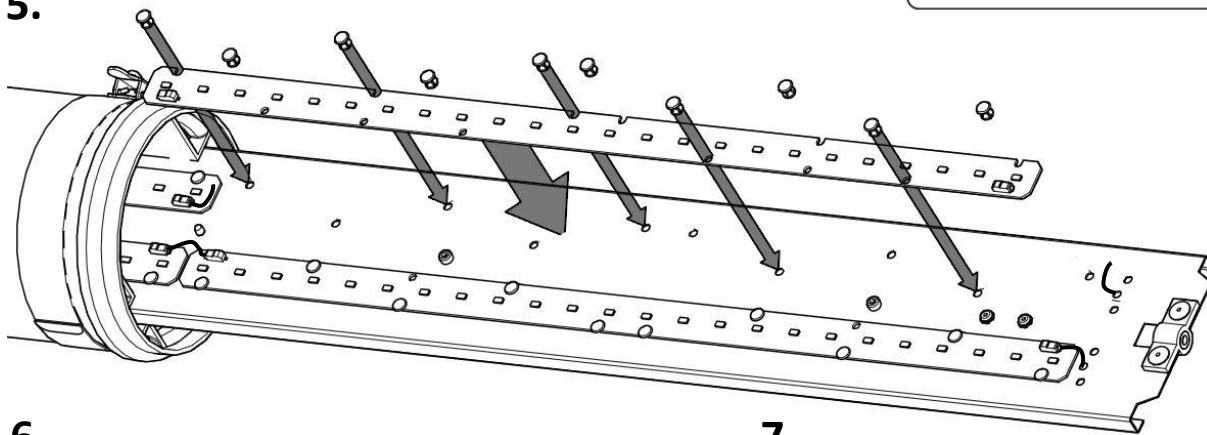

6.

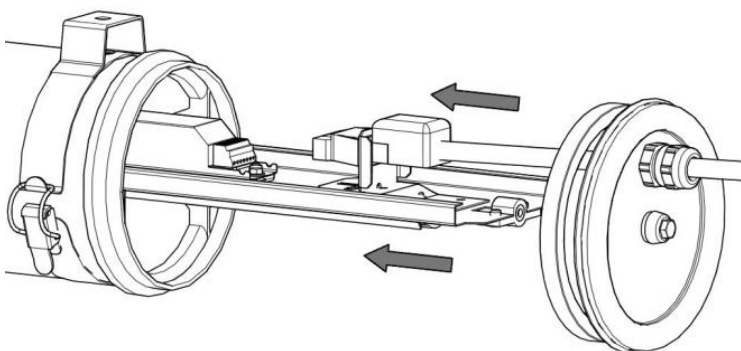

7.

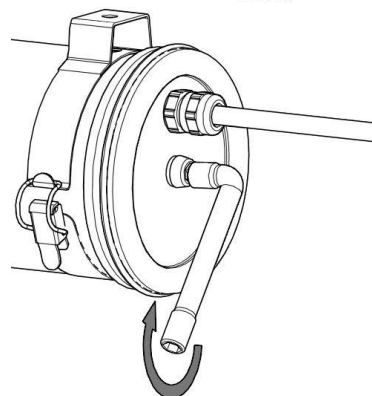

## 1. Position & câble / Position & cable / Position & kabel

Horizontal

Vertical

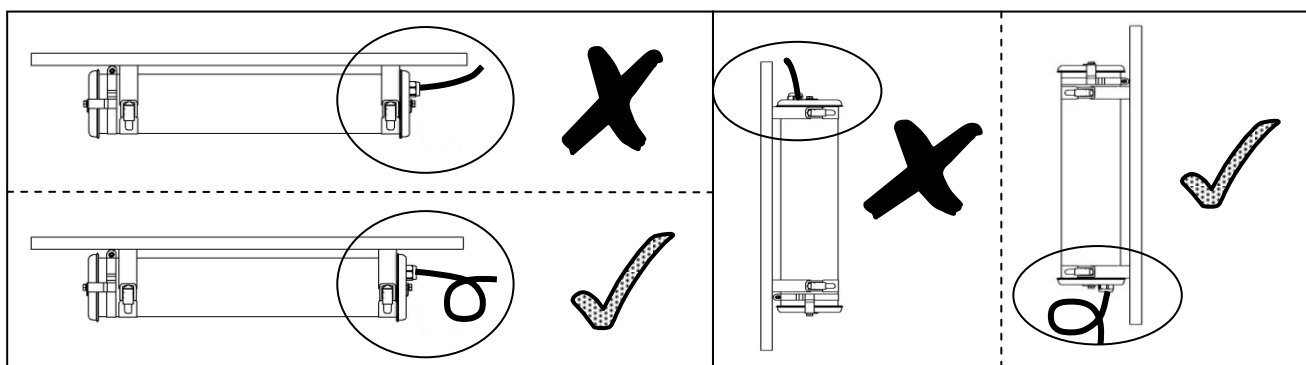

## 2. Flasques / End caps / Endkappen

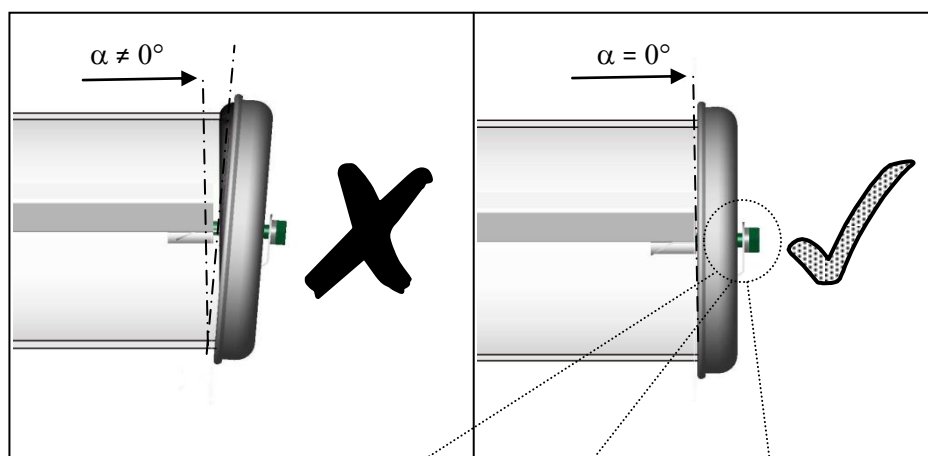

## 3. Vis centrale / Central screw / Zentrale schraube

