

BRONZINO 133



Sammode

Notice de montage

Mounting instruction / Montageanweisung

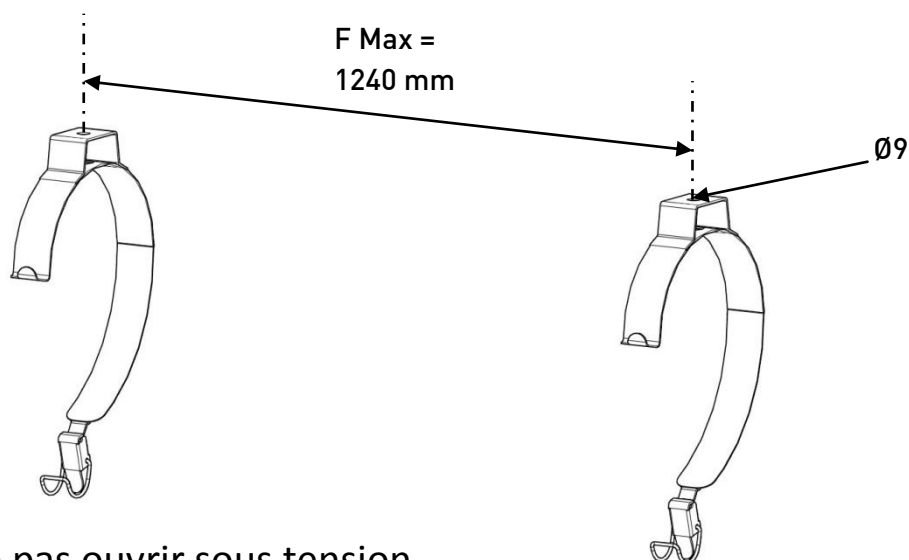
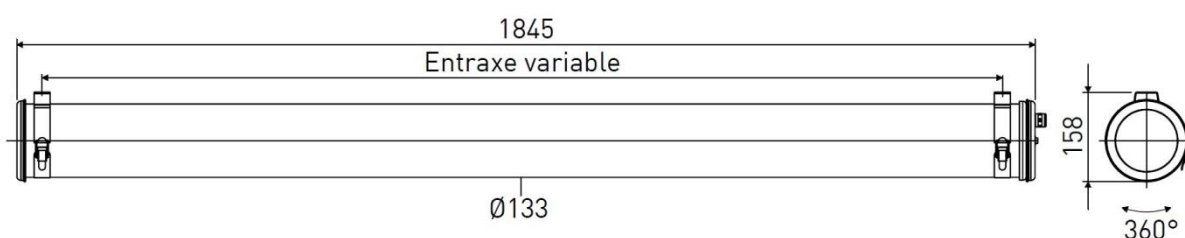

Ne pas ouvrir sous tension
Do not open when energized
Nicht unter Spannung öffne



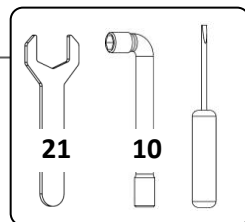

1.

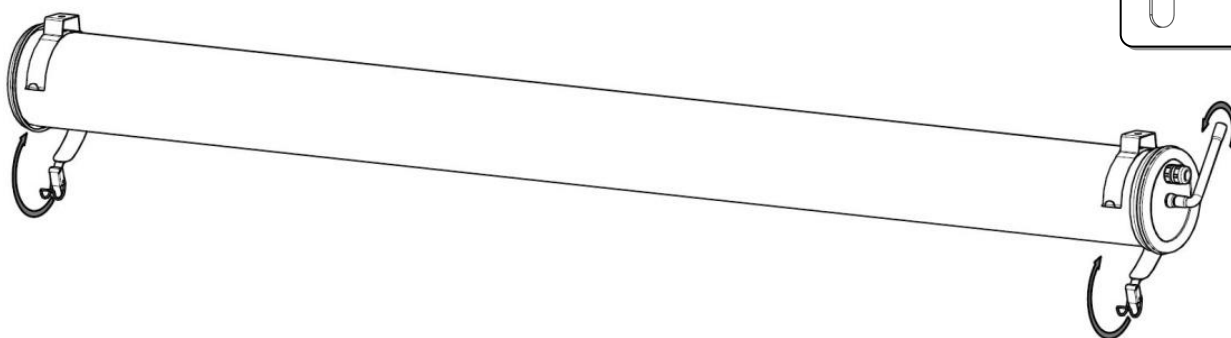

2.

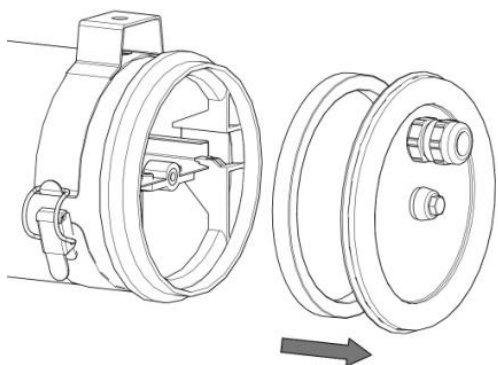

3.

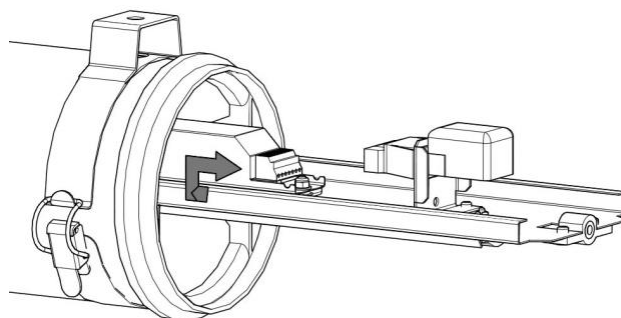

4.

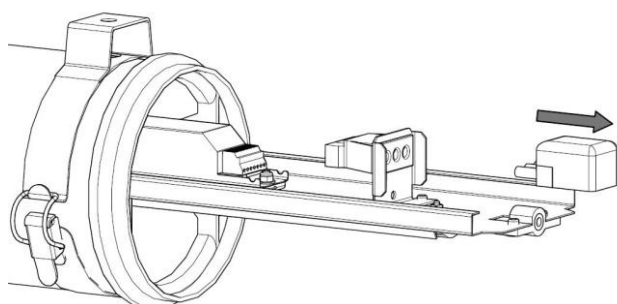

5.

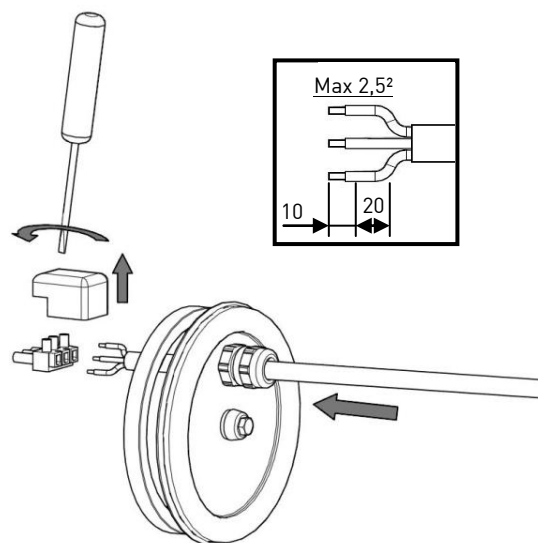

6.

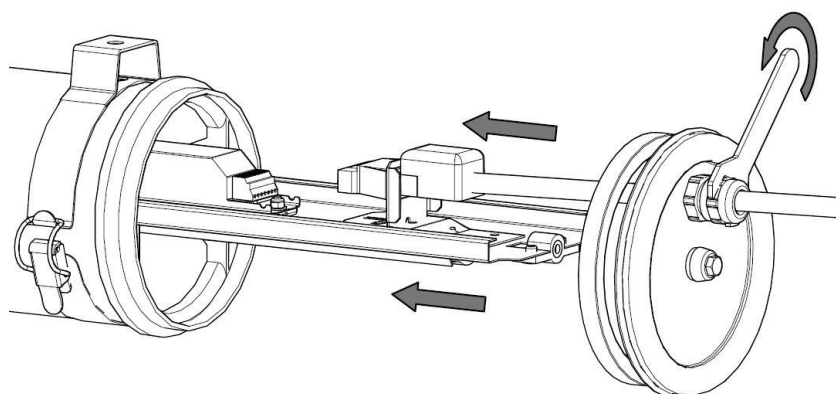

7.

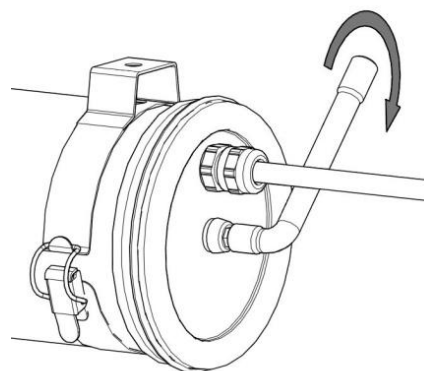

CAUTION

Composant sensible
aux décharges
électrostatiques

Electrostatic
sensitive device

Maintenance du module de LED

Replacement of LED Engine / Austausch der LED module

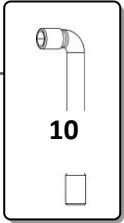

Ne pas ouvrir sous tension

Do not open when energized

Nicht unter Spannung öffne

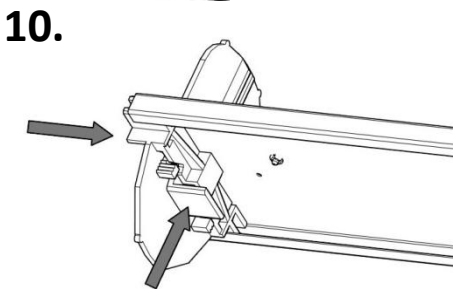
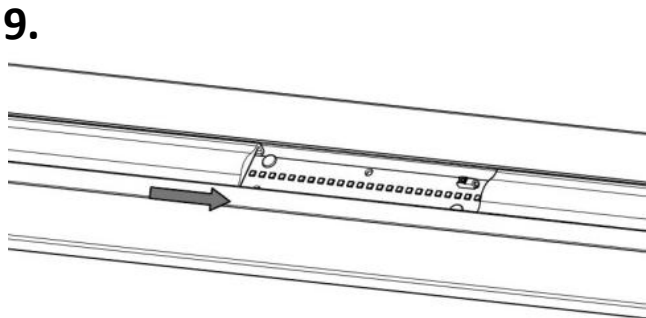
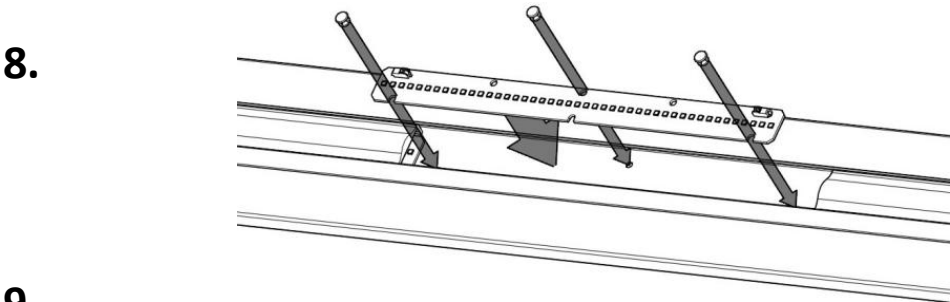
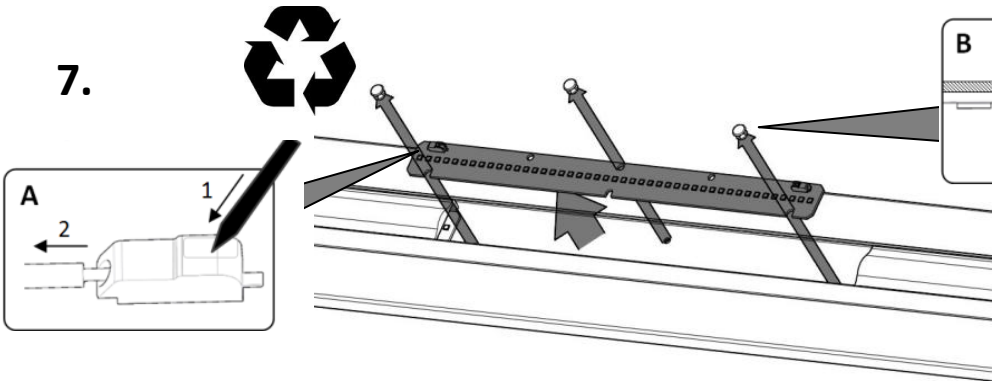
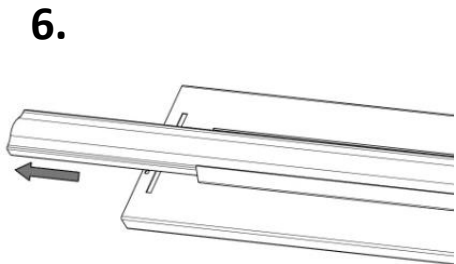
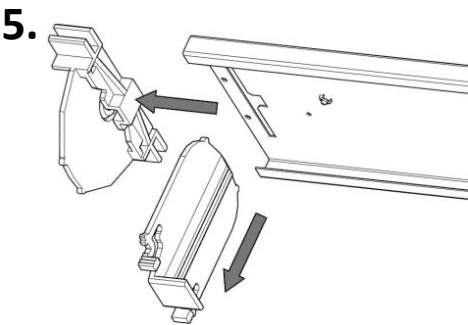
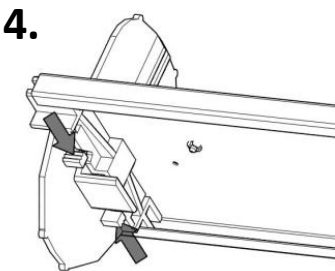
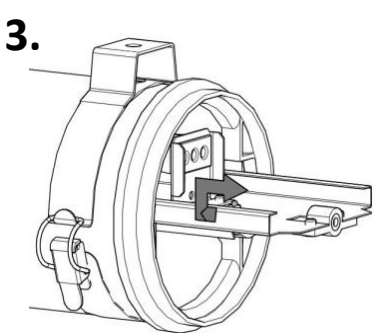
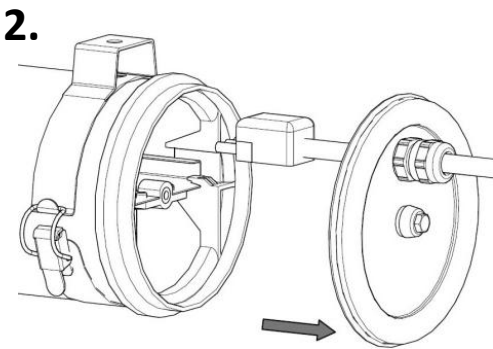
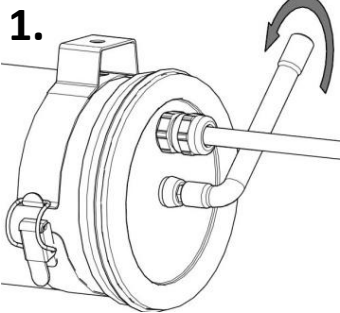

11.

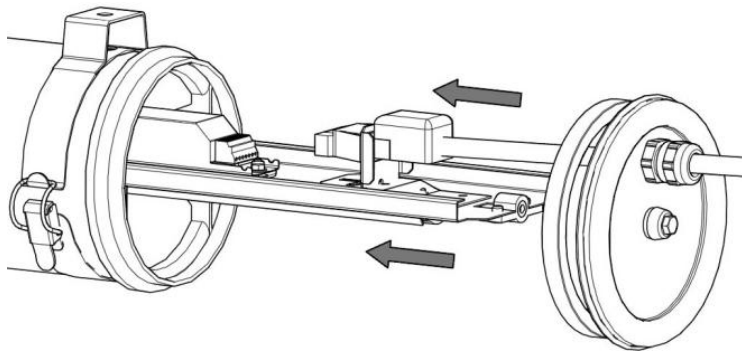

12.

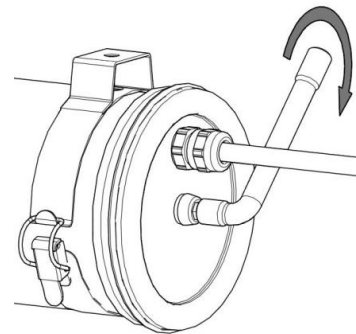

1. Position & câble / Position & cable / Position & kabel

Horizontal

Vertical

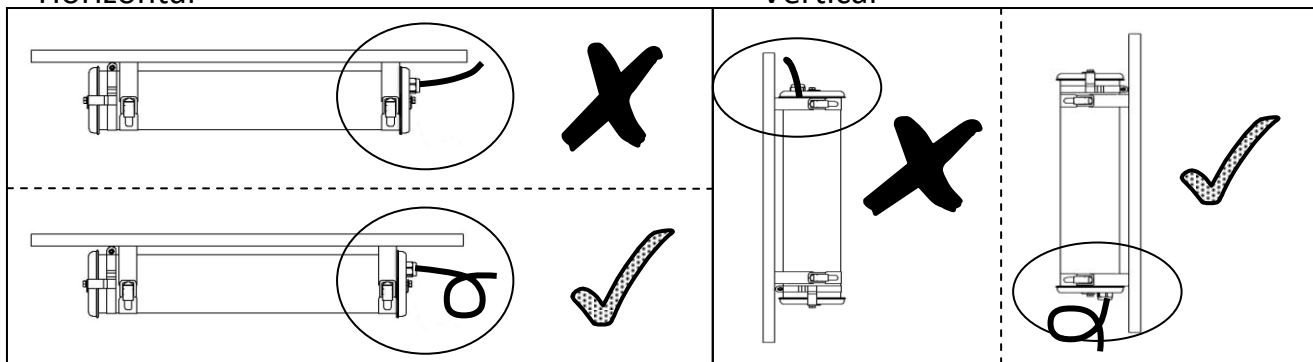

2. Flasques / End caps / Endkappen

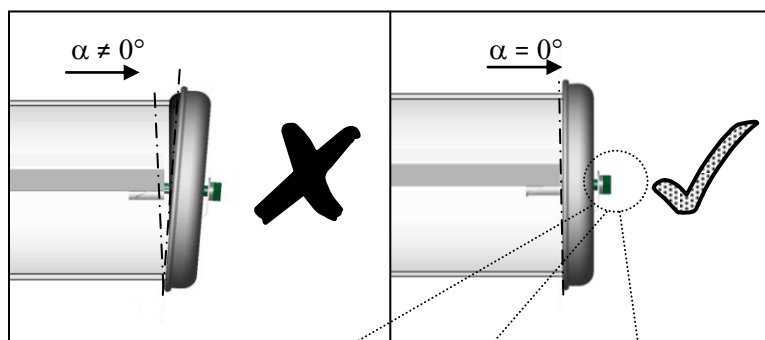

3. Vis centrale / Central screw / Zentrale schraube

