

CRANACH ... 213



Sammode

Traversant / Through wiring

/ Durchgangsverdrahtung

Notice de montage

Mounting instruction / Montageanweisung

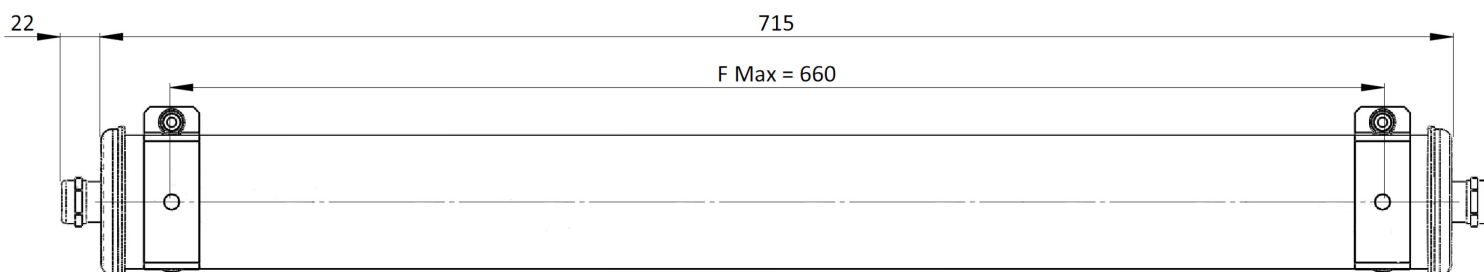
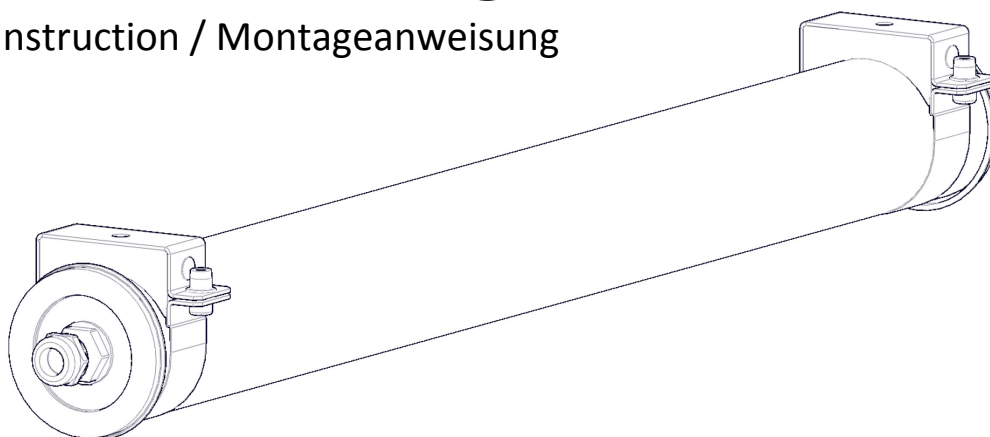

28 Luminares maxi en ligne/ Max of fitting in 1 line



Ne pas ouvrir sous tension
Do not open when energized
Nicht unter Spannung öffnen

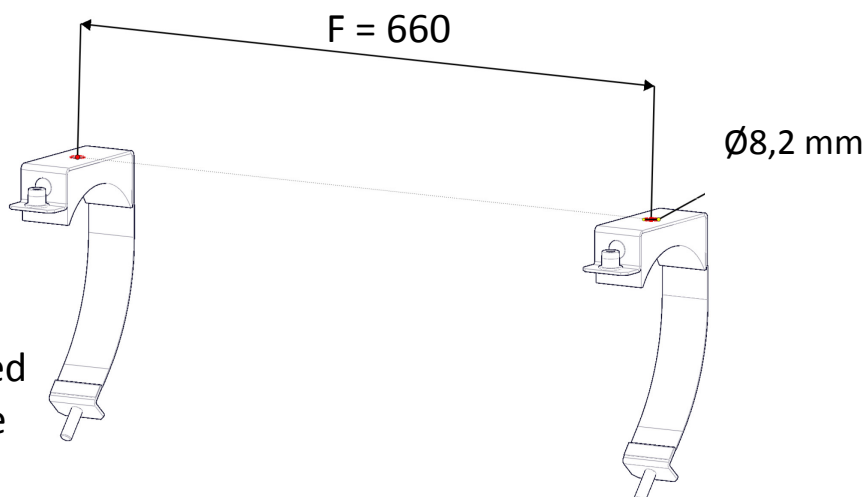

Installation & raccordement / Wiring / Verkabelung **x2**

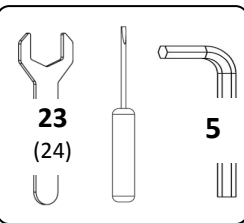

1.

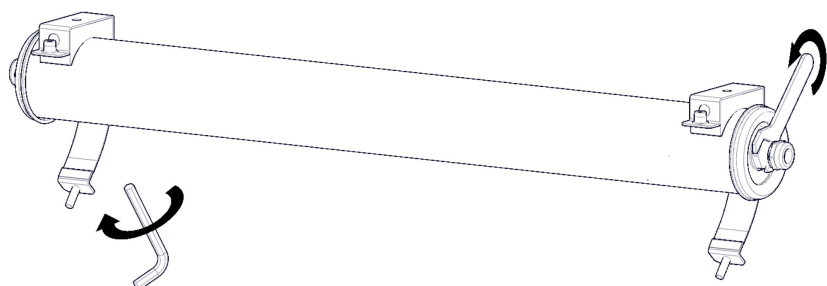

2.

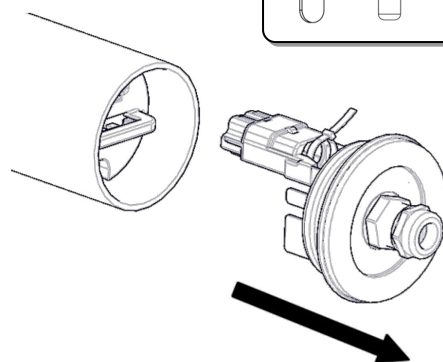

3.

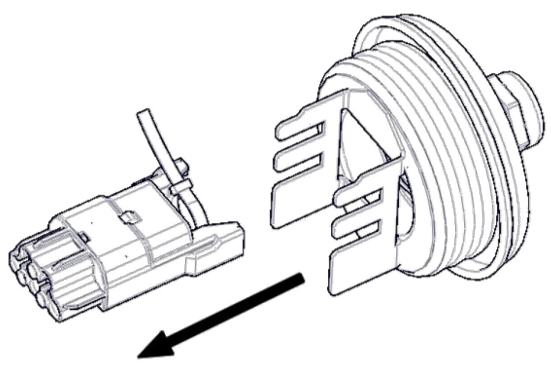

4.

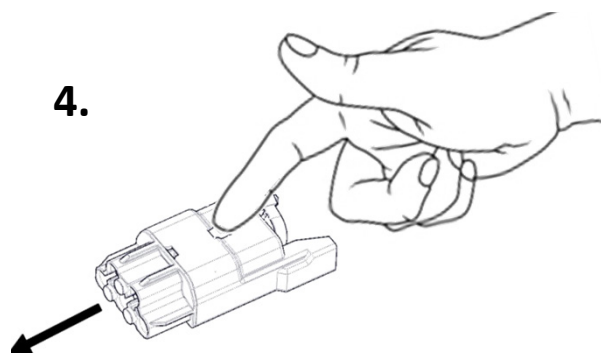

5.

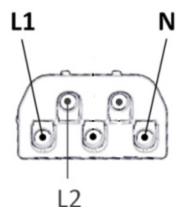

$\max 2.5^2$

7 15

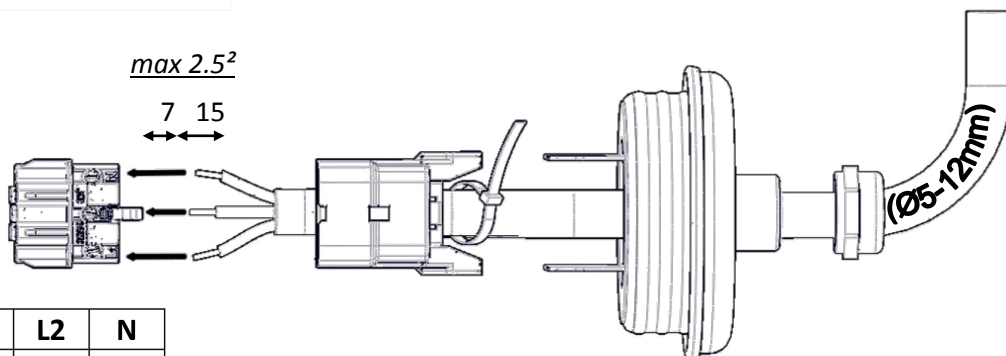

Modèle ON-OFF

	L1	L2	N
Modèle ON-OFF	L		N
Modèle ON-10% (...MV10)	L	L'	N

Modèle ON-10% (...MV10)

N.B.: Raccordement du modèle ON-10% / Wiring of the ON-10% version

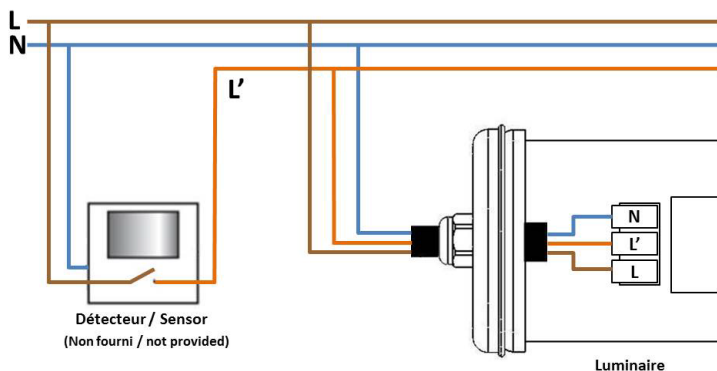

Comportement/Behaviour :

L	L'	
OFF	OFF	=> OFF
ON	OFF	=> 10%
ON	ON	=> ON



NE PAS MELANGER SUR LA PHASE DE CONSIGNE L' DES LUMINAIRES DE MODELES DIFFERENTS (versions ON-OFF et ON-10%, autres marques...)
DO NOT WIRE DIFFERENT KIND OF LUMINAIRES ON THE SAME L' LINE (ON-OFF or ON-10% versions, other manufacturers...)

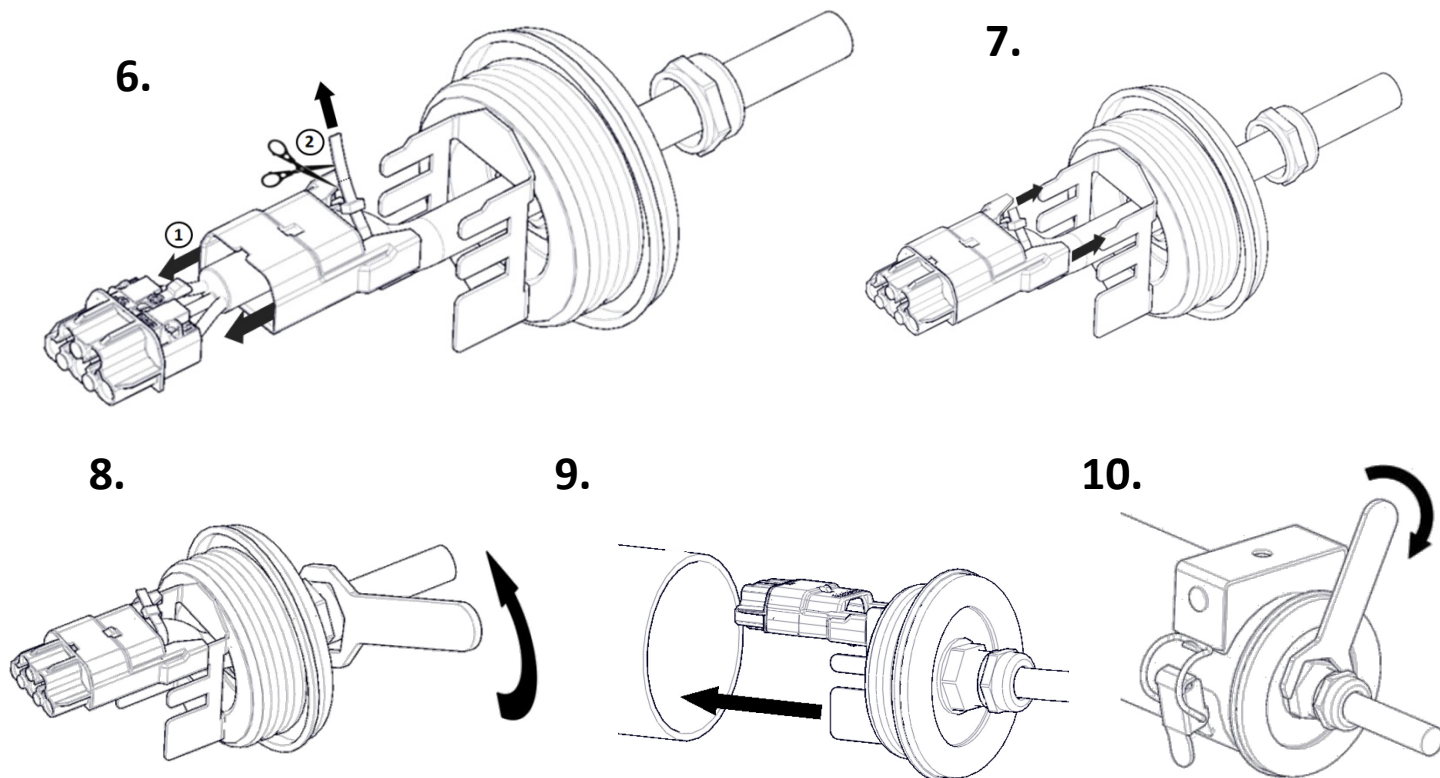

1. Flasques / End caps / Endkappen

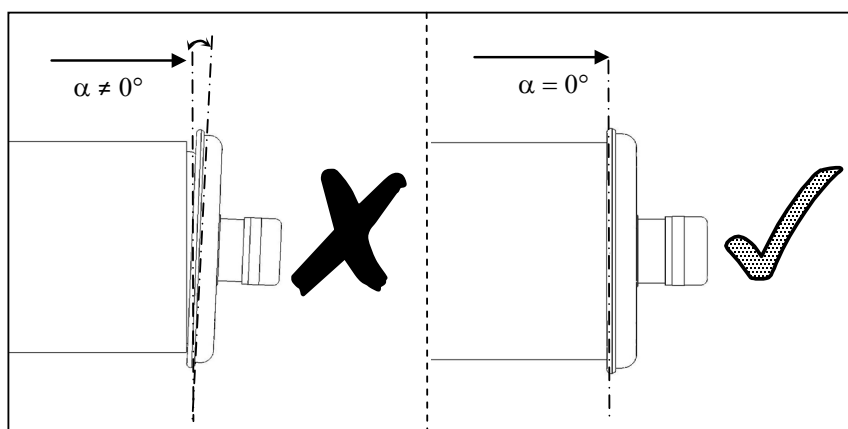

2. Joint d'étanchéité / Gasket / Dichtung

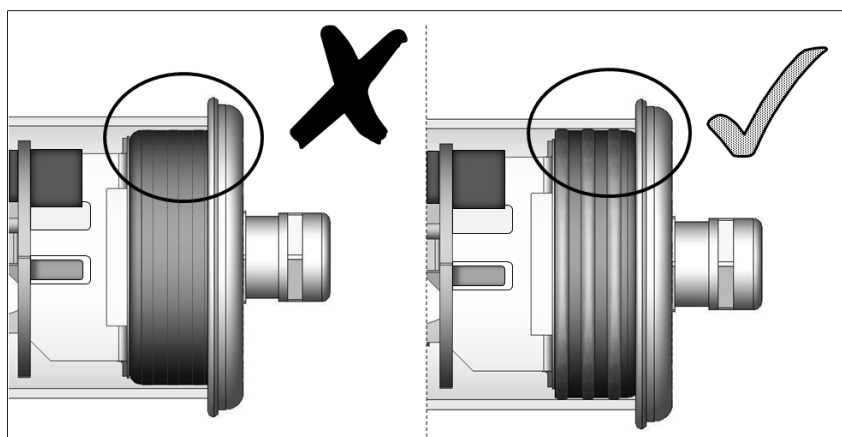

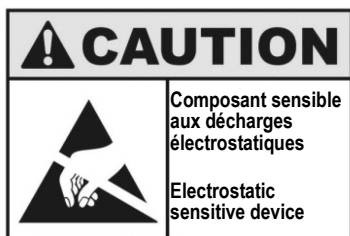

Maintenance du module de LED

Replacement of LED Engine / Austausch der LED module

