

# NIEPCE 70 MO

# NIEPCE 70 Ferro



Sammode

## Notice de montage

Mounting instruction

Montageanweisung

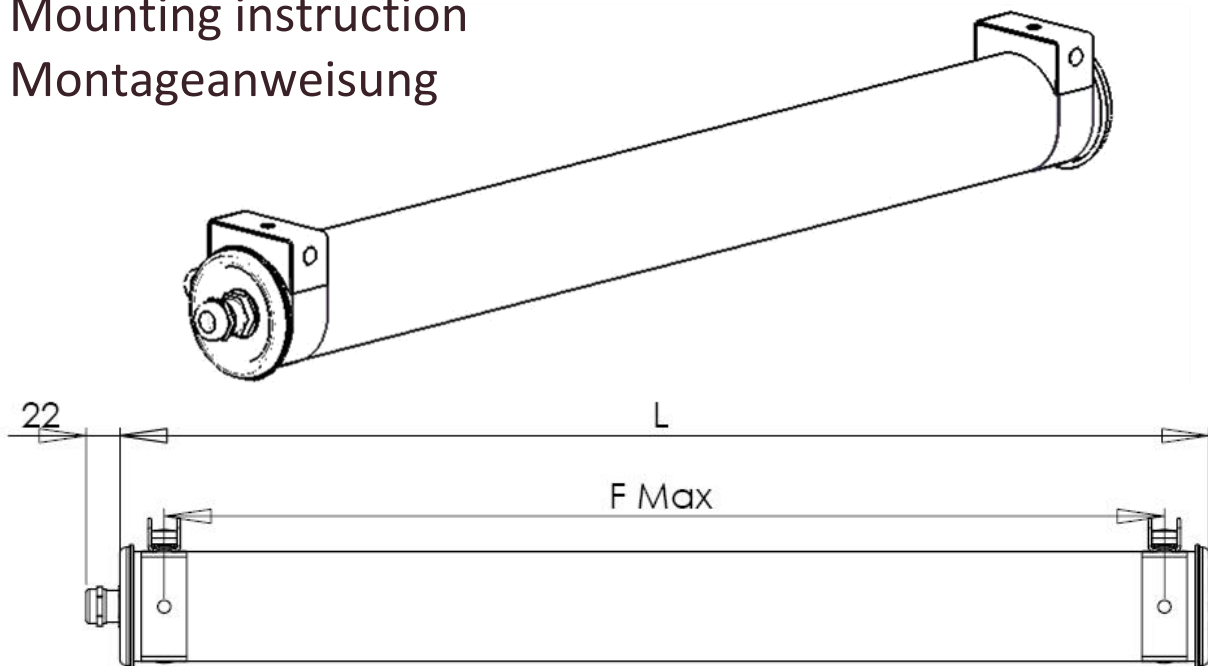

### NIEPCE 70 MO (T8 Ø26mm)

Electronique/Electronic

Type	F max (mm)	L (mm)
1x18 W	693	748

### NIEPCE 70 Ferro (T8 Ø26mm)

Ferromagnétique/Ferromagnetic

Type	F max (mm)	L (mm)
1x18 W	1025	1080
1x36 W	1635	1690
1x58 W	1975	2030



**Ne pas ouvrir sous tension**

**Do not open when energized**

**Nicht unter Spannung öffnen**

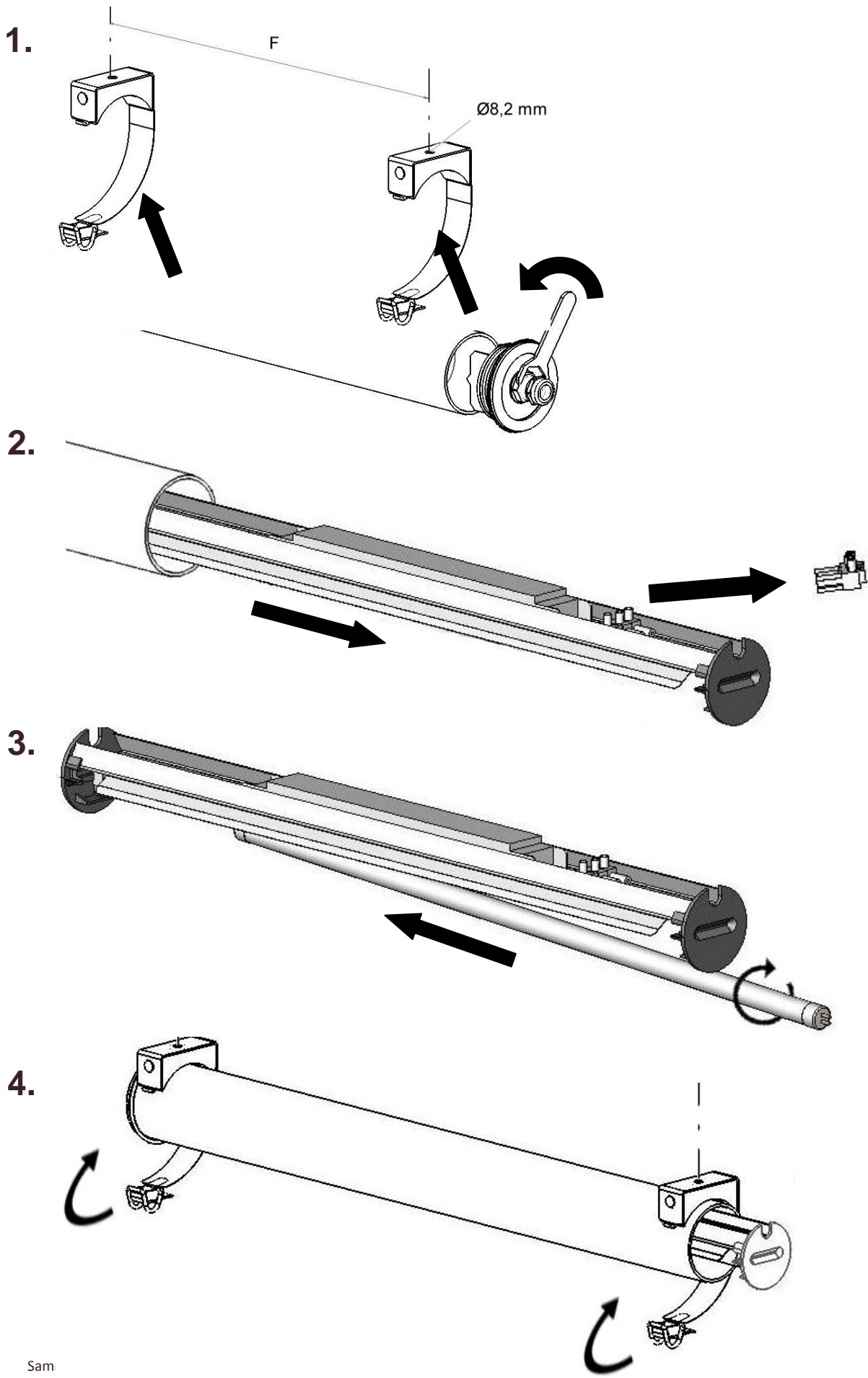

5. Classe I

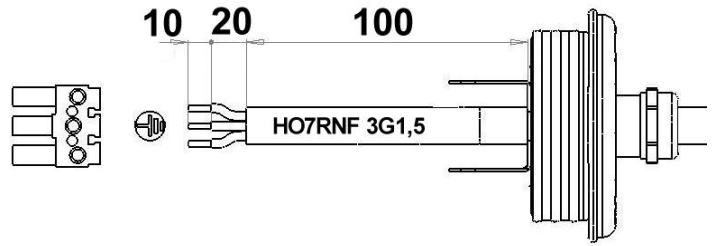
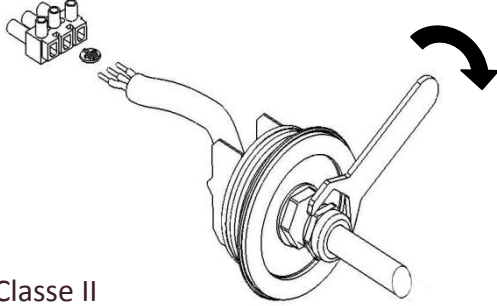

Classe II

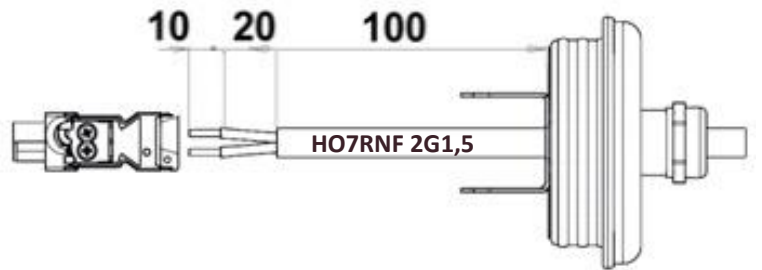
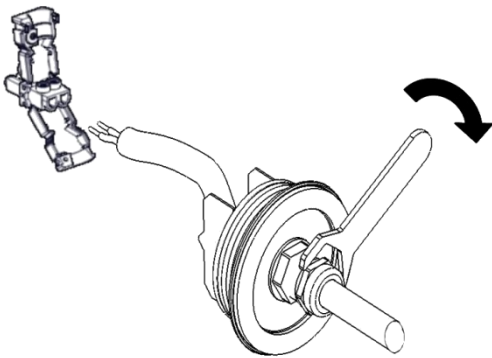

6.

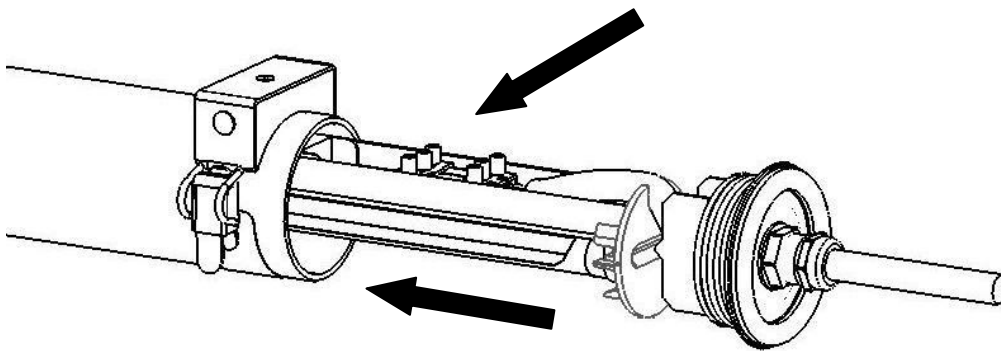

7.

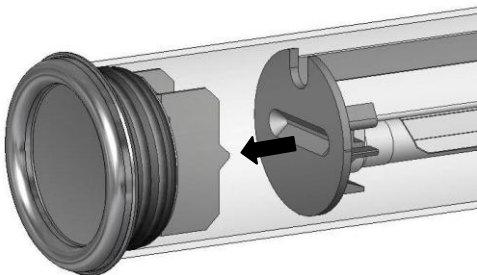

8.

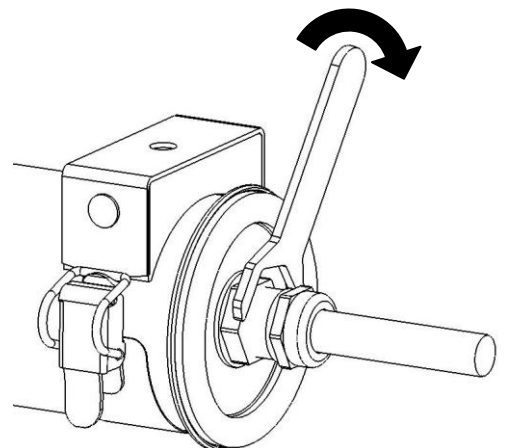
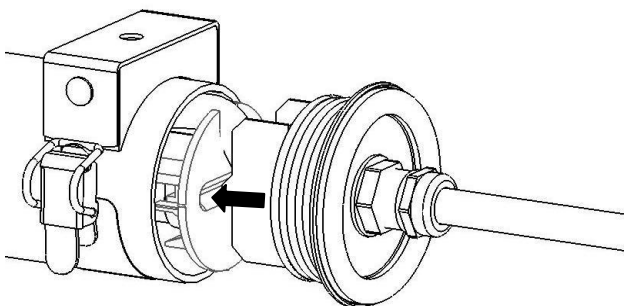

### 1. Position & câble / Position & cable / Position & kabel

Horizontal

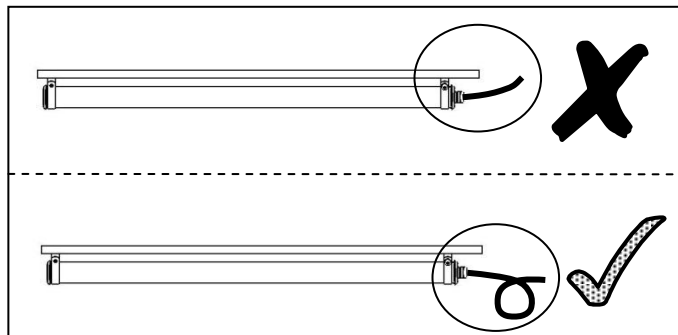

Vertical

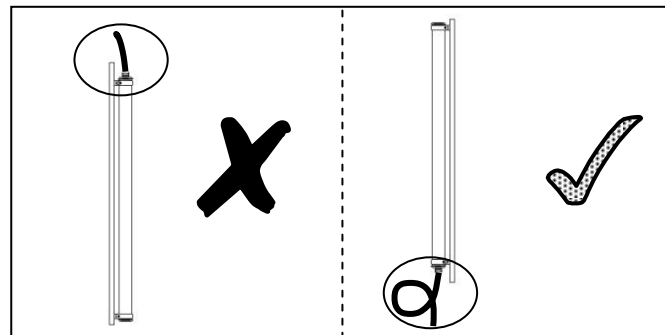

### 2. Flasques / End caps / Endkappen

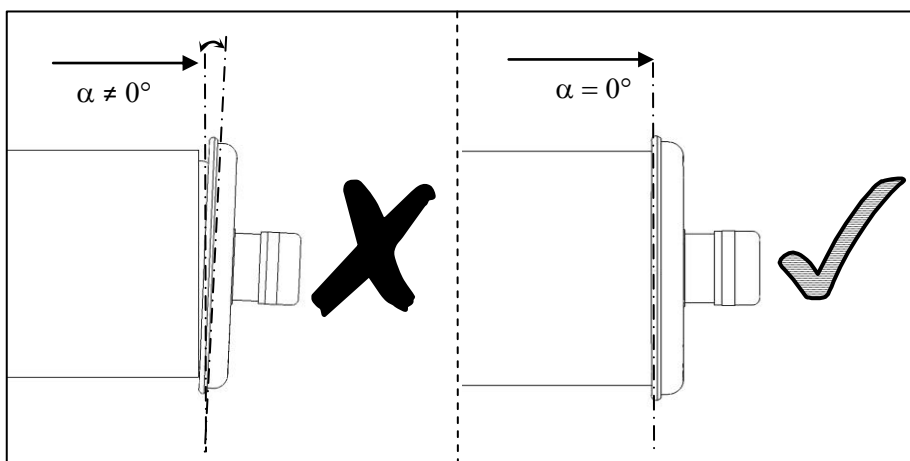

### 3. Vis centrale / Central screw / Zentrale schraube

